



concentric[™]
INTERNATIONAL

POWER TRANSMISSION SOLUTIONS

POWER TRANSMISSION INDEX

SPROCKETS	4	Roller Chain Couplings	42
#25 Bored-to-size Sprockets	5	INSERTS	43
#35 Bored-to-Size Sprockets	7	Rubber Insert	44
#40 Bored-to-Size Sprockets	9	Urethane Insert	45
#40 QD Standard Sprockets	11	Hytrell Insert	46
#50 Bored-to-Size Sprockets	12	COLLARS	47
#50 QD Standard Sprockets	13	Solid Shaft Collar	48
#60 Bored-to-Size Sprockets	14	Single Split Shaft Collar	49
#60 QD Standard Sprockets	15	Double Split Shaft Collar	50
#80 Bored-To-Size Sprockets	16	HUBS	51
#80 QD Standard Sprockets	17	V Series Weld-On Hub	52
#40 Series Weld-On Sprockets	18	W Series Weld-On Hub	53
#50 Series Weld-On Sprockets	20	X Series Weld-On Hub	54
#60 Series Weld-On Sprockets	22	Double Pulley Hub	55
#80 Series Weld-On Sprockets	23	Hex Bore Weld-On Hubs	56
Captured Bearing Idler Sprockets	24	Spline Bore Weld-On Hubs	57
Idler Sprocket with Precision Bearing	25	Square Bore Weld-On Hubs	58
SHEAVES	26	Idler Weld-On Hubs	59
Single Groove Cast Iron Sheave - H Bushed	27	PULLEYS	60
Double Groove Cast Iron Sheave - H Bushed	29	Split Steel Weld-On Pulley	61
Triple Groove Cast Iron Sheave - H Bushed	31	KEYED SHAFTING	62
Single Groove Cast Iron Sheaves - Finished Bore	32	Keyed Shafting	63
Double Groove Cast Iron Sheaves - Finished Bore	34	BUSHINGS	64
Triple Groove Cast Iron Sheave - Finished Bore	36	H Series Bushings	65
COUPLERS	37	QD Standard Bushings	66
Round and Hex Bore Shaft Coupler	38	CHAINS	68
L-Jaw Couplers	39	Roller Chain	69

ABOUT CONCENTRIC



concentric™
INTERNATIONAL

Concentric International connects retail, wholesale, and original equipment manufacturers (OEM) customers with the value of global sourcing for products in agricultural, construction, industrial, lawn and garden, professional turf and utility equipment.

Founded in 1983 by John Ruan, who also founded Ruan International in Des Moines, Iowa, our staff includes salespeople, engineers, logistics specialists, technicians, copywriters, and accountants who specialize in the introduction and implementation of products. In addition to sales, our staff routinely performs extended services in both international and domestic markets. With our full-service warehouse centrally located in Des Moines, Iowa, products can be shipped efficiently to any destination.



Concentric International serves as a single-point-of-contact for our customers. We remove all the barriers and potential headaches from global sourcing. We often integrate fully into our customers' manufacturing and supply networks, creating exceptional visibility and seamless flow of products and parts. We also partner with customers to overcome their new challenges, including continuous product improvement as well as new product engineering, design, development and production.

STANDARD KEYWAY AND SETSCREW SIZES FOR BORED TO SIZE SPROCKETS

Listed are the standard keyway and setscrew sizes furnished with corresponding bore sizes. These sizes will be furnished when keyway and/or setscrew size is not specified on an order.

If other than standard is required, specify when ordering.

Dimensions (In Inches Unless Otherwise Noted)		
Bore Size	Keyway Width X Depth	Setscrew
1/2 - 9/16	1/8 x 1/16	10-24
5/8 - 7/8	3/16 x 3/32	1/4
15/16 - 1 1/4	1/4 x 1/8	5/16
1 5/16 - 1 3/8	5/16 x 5/32	5/16
1 7/16 - 1 3/4	3/8 x 3/16	3/8
1 13/16 - 2 1/4	1/2 x 1/4	1/2
2 5/16 - 2 3/4	5/8 x 5/16	5/8
2 13/16 - 3 1/4	3/4 x 3/8	5/8
3 5/16 - 3 3/4	7/8 x 7/16	3/4
3 13/16 - 4 1/2	1 x 1/2	3/4

Standard Bore Tolerances	
1" and Under	+.001 to .000
1 1/16" to 2"	+.002 to .000
2 1/16" to 3"	+.003 to .000
3 1/16" and Up	+.004 to .000

POWER TRANSMISSION SOLUTIONS



Power Transmission Solutions, a division of Concentric International, offers an affordable line of stock and 'made-to-order' power transmission products. These products are used for planting/sowing equipment, specialized conveying equipment, harvesters and other industrial machines world wide.

Our factories are certified to ISO 9001 standards to ensure our standard and 'made-to-order' power transmission parts maintain the consistent quality demanded by OEMs.

Contact our Power Transmission Solutions Team member to discuss specific part designs, applications, needs, and other requirements to meet your OEM needs.

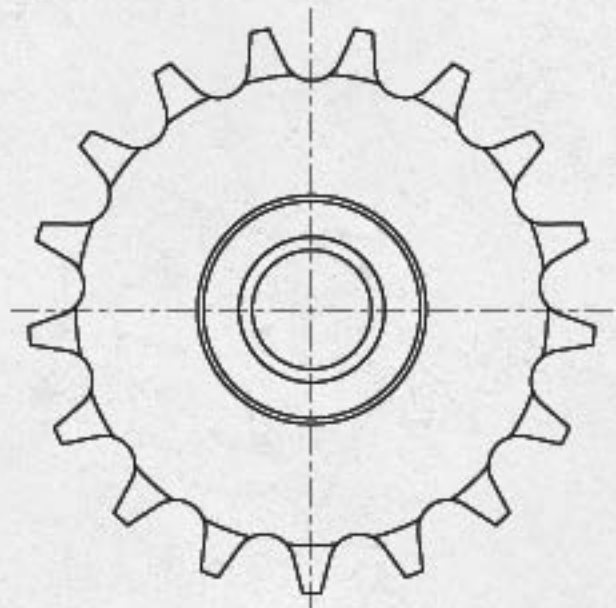

WARRANTY

Concentric International's PTS product line is designed to provide the end user with highly durable, long lasting products, which will perform well in all conditions.

Concentric International guarantees all of its PTS products against defects in material and workmanship. This guarantee does not cover failure due to abuse, or utilization in an application other than what the product was originally designed.

SPROCKETS



#25 BORED-TO-SIZE SPROCKETS

SPROCKETS

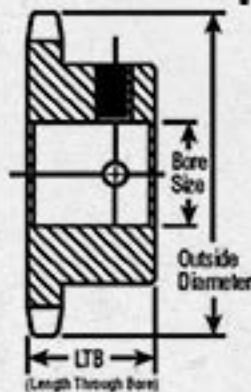

- Type BS (Bored To Size). Setscrews Are 90° Apart
- Black Oxide Finish
- Hub Sizes Vary To Suit Different Bore Sizes

Applications:

Robotics, copy machines, and light industrial machines.

No. Teeth	CI Part Number	Diameters (in.)		LTB	Finished Bores						Weight (Lbs.)
		Outside Diameter	Hub Diameter		1/4	5/16	3/8	1/2	5/8	3/4	
9	25BS09	0.84	7/16	1/2	X	-	-	-	-	-	0.03
10	25BS10	0.92	1/2	1/2	X	-	-	-	-	-	0.03
11	25BS11	1.00	9/16	1/2	X	X	-	-	-	-	0.04
12	25BS12	1.08	5/8	1/2	X	X	X	-	-	-	0.06
13	25BS13	1.17	23/32	1/2	X	X	X	-	-	-	0.07
14	25BS14	1.25	13/16	1/2	X	X	X	X	-	-	0.08
15	25BS15	1.33	57/64	1/2	X	X	X	X	-	-	0.10
16	25BS16	1.41	31/32	1/2	X	X	X	X	-	-	0.12
17	25BS17	1.49	1-1/32	1/2	X	X	X	X	X	-	0.14
18	25BS18	1.57	1-1/8	1/2	X	X	X	X	X	X	0.16
19	25BS19	1.65	1-7/32	1/2	X	-	X	X	X	X	0.19
20	25BS20	1.73	1-9/32	5/8	X	X	X	X	X	X	0.25
21	25BS21	1.81	1-3/8	5/8	X	X	X	X	X	X	0.28
22	25BS22	1.89	1-7/16	5/8	X	X	X	X	X	X	0.31

X = Current stock item, other bore requirements are available upon request.

#25 BORED-TO-SIZE SPROCKETS

SPROCKETS

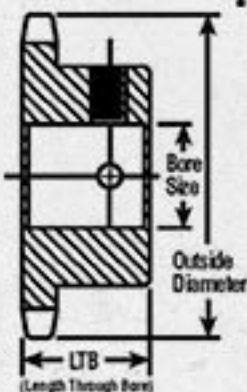

- Description:**
- Type BS (Bored To Size). Setscrews Are 90° Apart
 - Black Oxide Finish
 - Hub Sizes Vary To Suit Different Bore Sizes

Applications:
Robotics, copy machines, and light industrial machines.

No. Teeth	CI Part Number	Diameters (in.)		LTB	Finished Bores						Weight (Lbs.)
		Outside Diameter	Hub Diameter		1/4	5/16	3/8	1/2	5/8	3/4	
23	25BS23	1.97	1-1/2	5/8	X	X	X	X	X	X	0.32
24	25BS24	2.05	1-1/2	5/8	-	-	X	X	X	X	0.33
25	25BS25	2.13	1-1/2	5/8	-	-	X	X	X	X	0.34
26	25BS26	2.21	1-1/2	5/8	-	-	X	X	X	X	0.35
28	25BS28	2.37	1-1/2	5/8	-	-	X	X	X	X	0.36
30	25BS30	2.53	1-1/2	5/8	-	-	X	X	X	X	0.38
32	25BS32	2.69	1-1/2	5/8	-	-	X	X	X	X	0.40
35	25BS35	2.93	1-1/2	3/4	-	-	X	X	X	X	0.48
36	25BS36	3.01	1-1/2	3/4	-	-	X	X	X	X	0.50
40	25BS40	3.33	2	3/4	-	-	-	X	X	X	0.53
42	25BS42	3.49	2	3/4	-	-	-	X	X	X	0.55
45	25BS45	3.73	2	3/4	-	-	-	X	X	X	0.56
48	25BS48	3.96	2	3/4	-	-	-	X	X	X	0.56
54	25BS54	4.44	2	3/4	-	-	-	X	X	X	1.00
60	25BS60	4.92	2	3/4	-	-	-	X	X	X	1.10
72	25BS72	5.88	2	3/4	-	-	-	X	X	X	1.30

#35 BORED-TO-SIZE SPROCKETS

SPROCKETS

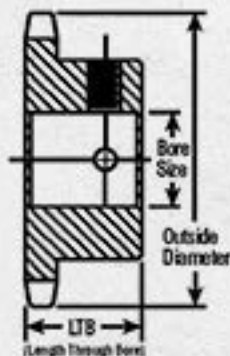

Description:

- Hardened Teeth
- Standard Keyway with (2) Setscrews
- Black Oxide Finish

Applications:

Robotics and light power transmission.

No. Teeth	CI Part Number	Diameter (in.)		LTB	Finished Bores										Weight (Lbs.)
		Outside Diameter	Hub Diameter		MPB	3/8	1/2	5/8	3/4	7/8	1	1-1/8	1-3/16	1-1/4	
10	35BS10H	1.38	31/32*	3/4	x	x	x	x	-	-	-	-	-	-	0.14
11	35BS11H	1.50	1-1/16*	3/4	x	x	x	x	x	-	-	-	-	-	0.17
12	35BS12H	1.63	1-7/32*	3/4	-	-	x	x	x	-	-	-	-	-	0.20
13	35BS13H	1.75	1-1/4	3/4	-	-	x	x	x	-	-	-	-	-	0.23
14	35BS14H	1.87	1-1/4	3/4	x	-	x	x	x	-	-	-	-	-	0.25
15	35BS15H	1.99	1-11/32	3/4	x	-	x	x	x	x	x	-	-	-	0.29
16	35BS16H	2.11	1-15/32	3/4	X	-	X	X	X	X	X	-	-	-	0.35
17	35BS17H	2.23	1-19/32	3/4	-	-	X	X	X	X	X	-	-	-	0.42
18	35BS18H	2.35	1-23/32	3/4	-	-	X	X	X	X	X	-	-	-	0.48
19	35BS19H	2.47	1-27/32	3/4	-	-	X	X	X	-	X	-	-	-	0.54
20	35BS20H	2.59	1-15/16	3/4	X	-	X	X	X	-	X	-	-	-	0.59
21	35BS21H	2.71	2	7/8	X	-	X	X	X	-	X	-	-	-	0.79
22	35BS22H	2.83	2	7/8	-	-	X	X	X	-	X	-	-	-	0.81
23	35BS23H	2.95	2	7/8	-	-	X	X	X	-	X	-	-	-	0.84
24	35BS24H	3.07	2	7/8	-	-	X	X	X	-	X	-	-	-	0.94

X = Current stock item, other bore requirements are available upon request.

#35 BORED-TO-SIZE SPROCKETS

SPROCKETS

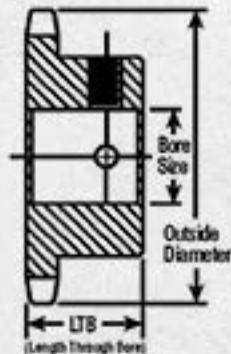

Description:

- Hardened Teeth
- Standard Keyway with (2) Setscrews
- Black Oxide Finish

Applications:

Robotics and light power transmission.

No. Teeth	CI Part Number	Diameter (in.)		LTB	Finished Bores										Weight (Lbs.)
		Outside Diameter	Hub Diameter		MPB	3/8	1/2	5/8	3/4	7/8	1	1-1/8	1-3/16	1-1/4	
25	35BS25H	3.19	2	7/8	-	-	X	X	X	-	X	-	-	-	0.97
26	35BS26H	3.31	2	7/8	-	-	-	X	X	X	X	X	X	X	0.99
27	35BS27H	3.43	2	7/8	-	-	-	X	X	X	X	X	X	X	1.01
28	35BS28H	3.55	2	7/8	-	-	-	X	X	X	X	X	X	X	1.06
29	35BS29H	3.66	2	7/8	-	-	-	X	X	X	X	X	X	X	1.08
30	35BS30H	3.79	2	7/8	-	-	-	X	X	X	X	X	X	X	1.12
32	35BS32	4.03	2	7/8	-	-	-	X	X	X	X	X	X	X	1.19
35	35BS35	4.39	2-1/4	7/8	-	-	-	X	X	X	X	X	X	X	1.30
36	35BS36	4.51	2-1/4	7/8	-	-	-	X	X	X	X	X	X	X	1.34
40	35BS40	4.99	2-1/4	1	-	-	-	X	X	X	X	X	X	X	1.87
42	35BS42	5.23	2-1/4	1	-	-	-	X	X	X	X	X	X	X	2.05
45	35BS45	5.59	2-1/4	1	-	-	-	X	X	X	X	X	X	X	2.20
48	35BS48	5.95	2-1/4	1	-	-	-	X	X	X	X	X	X	X	2.31
54	35BS54	6.66	2-1/4	1	-	-	-	X	X	X	X	X	X	X	2.42
60	35BS60	7.38	2-1/4	1	-	-	-	-	X	X	X	X	X	X	2.86
72	35BS72	8.81	2-1/4	1	-	-	-	-	X	X	X	X	X	X	3.42

#40 BORED-TO-SIZE SPROCKETS

SPROCKETS

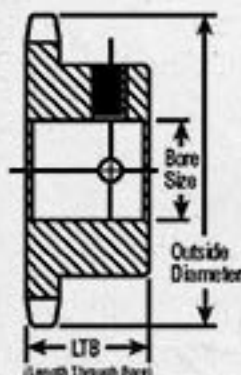

Description:

- Hardened Teeth
- Standard Keyway with (2) Setscrews
- Black Oxide Finish

Applications:

Ag and industrial .

No. Teeth	CI Part Number	Diameter (in.)		LTB	Finished Bores											Weight (Lbs.)
		Outside Diameter	Hub Diameter		1/2	5/8	3/4	7/8	1	1-1/8	1-3/16	1-1/4	1-3/8	1-7/16	1-1/2	
10	40BS10H	1.84	1-1/4*	7/8	X	X	X	-	-	-	-	-	-	-	-	0.24
11	40BS11H	2.00	1-3/8*	7/8	X	X	X	X	-	-	-	-	-	-	-	0.28
12	40BS12H	2.17	1-9/16*	7/8	X	X	X	X	X	-	-	-	-	-	-	0.34
13	40BS13H	2.33	1-9/16	7/8	X	X	X	X	X	-	-	-	-	-	-	0.45
14	40BS14H	2.49	1-11/16	7/8	X	X	X	X	X	X	X	-	-	-	-	0.51
15	40BS15H	2.65	1-13/16	7/8	X	X	X	X	X	X	X	X	-	-	-	0.53
16	40BS16H	2.81	2	7/8	-	X	X	X	X	X	X	X	-	-	-	0.66
17	40BS17H	2.98	2-1/8	1	-	X	X	X	X	X	X	X	-	-	-	0.88
18	40BS18H	3.14	2-5/16	1	-	X	X	X	X	X	X	X	X	X	X	1.03
19	40BS19H	3.30	2-1/2	1	-	X	X	X	X	X	X	X	X	X	X	1.17
20	40BS20H	3.46	2-5/8	1	-	X	X	X	X	X	X	X	X	X	X	1.33
21	40BS21H	3.62	2-3/4	1	-	X	X	-	X	X	X	X	X	X	X	1.53
22	40BS22H	3.78	2-7/8	1	-	X	X	X	X	X	X	X	-	X	X	1.66
23	40BS23H	3.94	3	1	-	X	X	X	X	-	X	X	X	X	X	1.92

X = Current stock item, other bore requirements are available upon request.

#40 BORED-TO-SIZE SPROCKETS

SPROCKETS

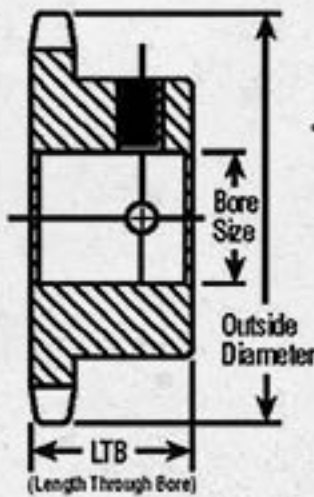

Description:

- Hardened Teeth
- Standard Keyway with (2) Setscrews
- Black Oxide Finish

Applications:

Ag and industrial.

No. Teeth	CI Part Number	Diameter (in.)		LTB	Finished Bores											Weight (Lbs.)	
		Outside Diameter	Hub Diameter		1/2	5/8	3/4	7/8	1	1-1/8	1-3/16	1-1/4	1-3/8	1-7/16	1-1/2		
24	40BS24H	4.10	3-1/4	1	-	X	X	X	X	X	X	X	X	X	X	X	2.10
25	40BS25H	4.26	3-1/4	1	-	-	X	X	X	X	X	X	-	-	X	2.22	
26	40BS26H	4.42	3-1/4	1	-	-	X	X	X	X	X	X	-	-	X	2.34	
27	40BS27H	4.58	3-1/4	1	-	-	X	X	X	X	X	X	-	-	X	2.42	
28	40BS28H	4.74	3-1/4	1	-	-	X	X	X	X	X	X	-	-	X	2.50	
29	40BS29H	4.90	3-1/4	1	-	-	X	X	X	X	X	X	-	-	X	2.60	
30	40BS30H	5.06	3-1/4	1	-	-	X	X	X	X	X	X	-	-	X	2.70	
33	40BS33H	5.54	3-1/4	1	-	-	X	-	X	-	-	-	-	-	X	3.03	
36	40BS36H	6.02	3-1/4	1	-	-	-	-	X	-	-	X	-	-	X	3.39	
40	40BS40H	6.65	3-1/2	1-1/8	-	-	X	-	X	-	-	-	-	-	-	4.28	
42	40BS42H	6.97	3-1/2	1-1/8	-	-	-	-	-	-	-	X	-	-	-	4.64	
43	40BS43H	7.13	3-1/2	1-1/8	-	-	X	-	-	-	-	-	-	-	-	4.80	
50	40BS50H	8.25	3-1/2	1-1/8	-	-	-	-	X	-	-	-	-	-	-	5.78	

X = Current stock item, other bore requirements are available upon request.

#40 QD STANDARD SPROCKETS

SPROCKETS

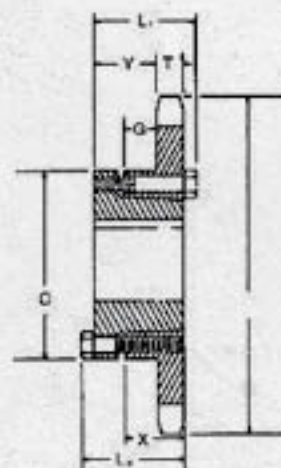

Description:

- Hardened Teeth
- For Use with QD Bushing
(see page 66)

Applications:

Ag and industrial equipment.

No. Teeth	CI Part Number	Bushing	Diameter (in.)		Type	Max. Bore	Dimensions							Weight Lbs. (Approx.)	
			Outside Diameter	Hub Diameter			L1	L2	C	Y	G	X	T	With Hub	Rim Only
15	40JA15H	JA	2.650	2.405	B	1-1/4	1-1/8	1-1/8	2-1/16	2-3/32	1-1/32	5/8	0.284	1.24	0.34
16	40JA16H	JA	2.810	2.563	B	1-1/4	1-1/8	1-1/8	2-1/16	2-3/32	1-1/32	5/8	0.284	1.30	0.40
17	40JA17H	JA	2.980	2.721	B	1-1/4	1-1/8	1-1/8	2-1/16	2-3/32	1-1/32	5/8	0.284	1.38	0.48
18	40JA18H	JA	3.140	2.879	B	1-1/4	1-1/8	1-1/8	2-1/16	2-3/32	1-1/32	5/8	0.284	1.44	0.54
19	40JA19H	JA	3.300	3.038	B	1-1/4	1-1/8	1-1/8	2-1/16	2-3/32	1-1/32	5/8	0.284	1.50	0.60
20	40SH20H	SH	3.460	3.196	B	1-5/8	1-7/16	1-7/16	2-11/16	3-1/32	1-7/32	1-3/16	0.284	1.78	0.76
21	40SH21H	SH	3.620	3.355	B	1-5/8	1-7/16	1-7/16	2-11/16	3-1/32	1-7/32	1-3/16	0.284	1.84	0.84
22	40SH22H	SH	3.780	3.513	B	1-5/8	1-7/16	1-7/16	2-11/16	3-1/32	1-7/32	1-3/16	0.284	1.92	0.92
23	40SH23H	SH	3.940	3.672	B	1-5/8	1-7/16	1-7/16	2-11/16	3-1/32	1-7/32	1-3/16	0.284	2.14	1.14
24	40SH24H	SH	4.100	3.831	B	1-5/8	1-7/16	1-7/16	2-11/16	3-1/32	1-7/32	1-3/16	0.284	2.22	1.22
25	40SH25H	SH	4.260	3.989	B	1-5/8	1-7/16	1-7/16	2-11/16	3-1/32	1-7/32	1-3/16	0.284	2.30	1.30
26	40SH26H	SH	4.420	4.148	B	1-5/8	1-7/16	1-7/16	2-11/16	3-1/32	1-7/32	1-3/16	0.284	2.44	1.44
28	40SH28H	SH	4.740	4.466	B	1-5/8	1-7/16	1-7/16	2-11/16	3-1/32	1-7/32	1-3/16	0.284	2.54	1.54
30	40SH30H	SH	5.060	4.783	B	1-5/8	1-7/16	1-7/16	2-11/16	3-1/32	1-7/32	1-3/16	0.284	2.72	1.72
32	40SH32H	SH	5.380	5.101	B	1-5/8	1-7/16	1-7/16	2-11/16	3-1/32	1-7/32	1-3/16	0.284	2.90	1.90
35	40SH35H	SH	5.860	5.578	B	1-5/8	1-7/16	1-7/16	3	3-1/32	1-7/32	1-3/16	0.284	3.22	2.22
36	40SDS36H	SDS	6.020	5.737	B	2	1-1/2	1-1/2	3-3/16	1-1/32	1-5/32	3/4	0.284	3.20	2.20
40	40SDS40H	SDS	6.650	6.373	B	2	1-1/2	1-1/2	3-3/16	1-1/32	1-5/32	3/4	0.284	3.72	2.72
42	40SDS42H	SDS	6.970	6.691	B	2	1-1/2	1-1/2	3-3/16	1-1/32	1-5/32	3/4	0.284	3.92	2.92
45	40SDS45H	SDS	7.450	7.168	B	2	1-1/2	1-1/2	3-3/16	1-1/32	1-5/32	3/4	0.284	4.32	3.32
48	40SDS48H	SDS	7.930	7.645	B	2	1-1/2	1-1/2	3-3/16	1-1/32	1-5/32	3/4	0.284	4.70	3.70

#50 BORED-TO-SIZE SPROCKETS

SPROCKETS

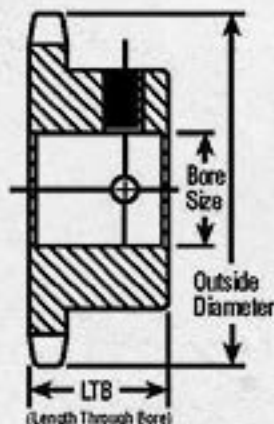

Description:

- Hardened Teeth
- Standard Keyway with (2) Setscrews
- Black Oxide Finish

Applications:

Ag and industrial equipment.

No. Teeth	CI Part Number	Diameter (in.)		LTB	Finished Bores														Weight (Lbs.)
		Outside Diameter	Hub Diameter		5/8	3/4	7/8	1	1-1/8	1-3/16	1-1/4	1-3/8	1-7/16	1-1/2	1-5/8	1-3/4	1-7/8	1-15/16	
9	50BS09H	2.09	1-3/8*	1	-	X	-	-	-	-	-	-	-	-	-	-	-	-	0.30
10	50BS10H	2.30	1-9/16*	1	X	X	X	X	-	-	-	-	-	-	-	-	-	-	0.30
11	50BS11H	2.50	1-3/4*	1	X	X	X	X	-	-	-	-	-	-	-	-	-	-	0.60
12	50BS12H	2.71	1-63/64	1	X	X	X	X	X	X	X	-	-	-	-	-	-	-	0.70
13	50BS13H	2.91	1-7/8	1	X	X	X	X	X	X	X	-	-	-	-	-	-	-	0.80
14	50BS14H	3.11	2-1/8	1	X	X	X	X	X	X	X	-	-	-	-	-	-	-	1.00
15	50BS15H	3.32	2-3/8	1	X	X	X	X	X	X	X	X	X	X	-	-	-	-	1.20
16	50BS16H	3.52	2-1/2	1	X	X	X	X	X	X	X	X	X	X	X	-	-	-	1.45
17	50BS17H	3.72	2-11/16	1	X	X	X	X	X	X	X	X	X	X	X	-	-	-	1.60
18	50BS18H	3.92	2-7/8	1	X	X	X	X	X	X	X	X	X	X	X	-	-	-	1.90
19	50BS19H	4.12	3	1	X	X	X	X	X	X	X	X	X	X	X	-	-	-	2.00
20	50BS20H	4.32	3	1	-	X	X	-	X	X	X	X	X	X	X	-	-	-	2.10
21	50BS21H	4.52	3	1	-	X	X	X	X	X	X	X	X	X	-	-	-	-	2.25
22	50BS22H	4.72	3	1	-	X	X	X	X	X	X	X	X	X	-	-	-	-	2.40
23	50BS23H	4.92	3	1	-	X	X	X	X	X	X	X	X	X	-	-	-	-	2.50
24	50BS24H	5.12	3	1-1/4	-	X	X	X	X	X	X	X	X	X	-	-	-	-	3.00
25	50BS25H	5.32	3	1-1/4	-	X	X	X	X	X	X	X	X	X	-	-	-	-	3.10
26	50BS26H	5.52	3	1-1/4	-	X	X	X	X	X	X	X	X	X	-	-	-	-	3.30
27	50BS27H	5.72	3	1-1/4	-	X	X	X	X	X	X	X	X	X	-	-	-	-	3.46
28	50BS28H	5.92	3	1-1/4	-	X	X	X	X	X	X	X	X	X	-	-	-	-	3.60
29	50BS29H	6.12	3	1-1/4	-	X	X	X	X	X	X	X	X	X	-	-	-	-	3.78
30	50BS30H	6.32	3-1/4	1-1/4	-	X	X	X	X	X	X	X	X	X	-	-	-	-	3.90
34	50BS34H	7.12	3-1/4	1-1/4	-	X	X	X	X	X	X	X	X	X	-	X	-	X	5.06
36	50BS36H	7.52	3-1/4	1-1/4	-	-	-	-	-	-	X	-	-	-	-	-	-	-	5.50
40	50BS40H	8.32	3-1/4	1-1/4	-	X	X	X	X	X	X	X	X	X	-	X	X	X	6.20
45	50BS45H	9.31	3-3/4	1-1/4	-	-	-	-	X	X	-	X	X	X	-	X	X	X	8.00

#50 QD STANDARD SPROCKETS

SPROCKETS

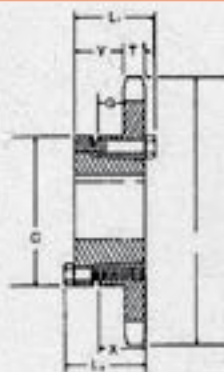

Description:

- Hardened Teeth
- For Use with QD Bushing
(see page 66)

Applications:

Ag and industrial equipment.

No. Teeth	CI Part Number	Bushing	Diameter (in.)		Type	Max. Bore	Dimensions							Weight Lbs. (Approx.)	
			Outside Diameter	Hub Diameter			L1	L2	C	Y	G	X	T	With Hub	Rim Only
12	50JA12H	JA	2.710	2.415	B	1-14	1-18	1-18	2-1/16	21/32	9/32	58	0.343	1.24	0.34
13	50JA13H	JA	2.910	2.612	B	1-14	1-18	1-18	2-1/16	21/32	9/32	58	0.343	1.30	0.40
14	50JA14H	JA	3.110	2.803	B	1-14	1-18	1-18	2-1/16	21/32	9/32	58	0.343	1.45	0.52
15	50JA15H	JA	3.320	3.006	B	1-14	1-18	1-18	2-1/16	21/32	9/32	58	0.343	1.50	0.60
16	50JA16H	JA	3.520	3.204	B	1-14	1-18	1-18	2-1/16	21/32	9/32	58	0.343	1.58	0.68
17	50SH17H	SH	3.720	3.401	B	1-58	1-7/16	1-7/16	2-11/16	29/32	15/32	13/16	0.343	1.84	0.84
18	50SH18H	SH	3.920	3.599	B	1-58	1-7/16	1-7/16	2-11/16	29/32	15/32	13/16	0.343	2.04	1.04
19	50SH19H	SH	4.120	3.797	B	1-58	1-7/16	1-7/16	2-11/16	29/32	15/32	13/16	0.343	2.24	1.24
20	50SDS20H	SDS	4.320	3.995	B	2	1-1/2	1-1/2	3-3/16	31/32	13/32	34	0.343	2.20	1.20
21	50SDS21H	SDS	4.520	4.194	B	2	1-1/2	1-1/2	3-3/16	31/32	13/32	34	0.343	2.32	1.32
22	50SDS22H	SDS	4.720	4.392	B	2	1-1/2	1-1/2	3-3/16	31/32	13/32	34	0.343	2.48	1.42
23	50SDS23H	SDS	4.920	4.590	B	2	1-1/2	1-1/2	3-3/16	31/32	13/32	34	0.343	2.58	1.58
24	50SDS24H	SDS	5.120	4.788	B	2	1-1/2	1-1/2	3-3/16	31/32	13/32	34	0.343	2.70	1.70
25	50SDS25H	SDS	5.320	4.987	B	2	1-1/2	1-1/2	3-3/16	31/32	13/32	34	0.343	2.86	1.86
26	50SDS26H	SDS	5.520	5.185	B	2	1-1/2	1-1/2	3-3/16	31/32	13/32	34	0.343	3.00	2.00
27	50SDS27H	SDS	5.720	5.384	B	2	1-1/2	1-1/2	3-3/16	31/32	13/32	34	0.343	3.12	2.12
28	50SDS28H	SDS	5.920	5.582	B	2	1-1/2	1-1/2	3-3/16	31/32	13/32	34	0.343	3.32	2.32
30	50SDS30H	SDS	6.320	5.979	B	2	1-1/2	1-1/2	3-3/16	31/32	13/32	34	0.343	3.64	2.64
32	50SDS32H	SDS	6.720	6.376	B	2	1-1/2	1-1/2	3-3/16	31/32	13/32	34	0.343	3.98	2.98
35	50SDS35H	SDS	7.320	6.972	B	2	1-1/2	1-1/2	3-3/16	31/32	13/32	34	0.343	4.62	3.62
36	50SDS36H	SDS	7.520	7.171	B	2	1-1/2	1-1/2	3-3/16	31/32	13/32	34	0.343	4.64	3.64
40	50SDS40H	SDS	8.320	7.966	B	2	1-1/2	1-1/2	3-3/16	31/32	13/32	34	0.343	5.74	4.74
42	50SDS42H	SDS	8.720	8.363	B	2	1-1/2	1-1/2	3-3/16	31/32	13/32	34	0.343	6.40	5.40
45	50SDS45H	SDS	9.310	8.960	B	2	1-1/2	1-1/2	3-3/16	31/32	13/32	34	0.343	6.90	5.90
48	50SDS48H	SDS	9.910	9.556	B	2	1-1/2	1-1/2	3-3/16	31/32	13/32	34	0.343	7.66	6.66

X = Current stock item, other bore requirements are available upon request.

#60 BORED-TO-SIZE SPROCKETS

SPROCKETS

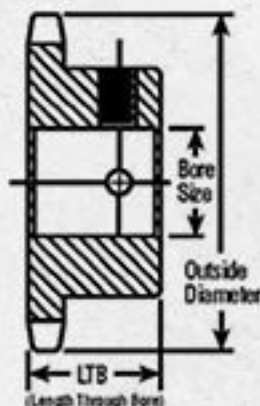

Description:

- Hardened Teeth
- Standard Keyway with (2) Setscrews
- Black Oxide Finish

Applications:

Ag and industrial equipment.

No. Teeth	CI Part Number	Diameter (in.)		LTB	Finished Bores																			Weight (Lbs.)
		Outside Diameter	Hub Diameter		5/8	3/4	7/8	1	1-1/8	1-3/16	1-1/4	1-3/8	1-7/16	1-1/2	1-5/8	1-3/4	1-7/8	1-15/16	2					
10	60BS10H	2.76	1-15/16*	1-1/4	-	X	X	X	X	X	X	-	-	-	-	-	-	-	-	-	-	0.70		
11	60BS11H	3.00	2-1/16*	1-1/4	X	X	X	X	X	X	X	-	-	-	-	-	-	-	-	-	-	0.90		
12	60BS12H	3.25	2-3/8*	1-1/4	-	X	X	X	X	X	X	-	-	-	-	-	-	-	-	-	-	1.30		
13	60BS13H	3.49	2-11/32	1-1/4	-	X	X	X	X	X	X	X	X	X	-	-	-	-	-	-	-	1.30		
14	60BS14H	3.74	2-9/16	1-1/4	-	X	X	X	X	X	X	X	X	X	-	-	-	-	-	-	-	1.60		
15	60BS15H	3.98	2-7/8	1-1/4	-	X	X	X	X	X	X	X	X	X	X	-	-	-	-	-	-	1.70		
16	60BS16H	4.22	3-1/16	1-1/4	-	X	X	X	X	X	X	X	X	X	X	X	-	-	X	-	-	2.10		
17	60BS17H	4.46	3-1/4	1-1/4	-	-	-	X	X	X	X	X	X	X	X	X	X	X	X	X	-	2.40		
18	60BS18H	4.70	3-1/2	1-1/4	-	-	-	X	X	X	X	X	X	X	X	X	X	X	X	X	X	2.60		
19	60BS19H	4.95	3-1/2	1-1/4	-	-	-	X	X	X	X	X	X	X	X	X	X	X	X	X	-	3.40		
20	60BS20H	5.19	3-7/8	1-1/4	-	-	-	X	X	X	X	X	X	X	X	X	X	X	X	X	X	3.90		
21	60BS21H	5.43	4	1-1/4	-	-	-	X	X	X	X	X	X	X	X	X	X	X	X	X	-	4.40		
22	60BS22H	5.67	4	1-1/4	-	-	-	X	X	X	X	-	X	X	X	X	X	X	X	X	X	4.70		
23	60BS23H	5.91	4	1-1/4	-	-	-	X	X	X	X	X	X	X	X	X	X	X	X	X	-	5.00		
24	60BS24H	6.15	4	1-1/4	-	-	-	X	X	X	X	X	X	X	X	X	X	X	X	X	X	5.30		
25	60BS25H	6.39	4	1-1/4	-	-	-	-	X	-	-	X	-	-	-	-	-	-	-	-	-	5.40		
26	60BS26H	6.63	4	1-1/4	-	-	-	X	X	X	X	X	X	X	X	X	X	X	X	X	X	5.80		
27	60BS27H	6.87	4	1-1/4	-	-	-	X	X	X	X	X	X	X	X	X	X	X	X	X	-	6.30		
28	60BS28H	7.11	4	1-1/4	-	-	-	X	X	X	X	X	X	X	X	X	X	X	X	X	X	6.40		
30	60BS30H	7.59	4	1-1/4	-	-	-	X	X	X	X	X	X	X	X	X	X	X	X	X	-	7.10		
32	60BS32H	8.07	4	1-1/4	-	-	-	X	X	X	X	X	X	X	X	X	X	X	X	X	X	7.80		
35	60BS35H	8.78	4	1-1/4	-	-	-	X	X	X	X	X	X	X	X	X	X	X	X	X	X	8.80		
38	60BS38H	9.50	4-1/4	1-1/4	-	-	-	-	-	-	-	-	-	-	-	-	X	-	-	-	-	10.50		
46	60BS46H	11.42	4-1/4	1-1/4	-	-	-	-	-	-	-	-	-	-	X	-	-	-	-	-	-	14.10		
40	50BS40H	8.32	3-1/4	1-1/4	-	X	X	X	X	X	X	X	X	X	X	-	X	X	X	-	-	6.20		
45	50BS45H	9.31	3-3/4	1-1/4	-	-	-	-	X	X	-	X	X	X	-	X	X	X	-	-	-	8.00		

#60 QD STANDARD SPROCKETS

SPROCKETS

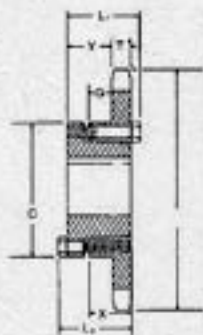

Description:

- Hardened Teeth
- For Use with QD Bushing
(see page 66)

Applications:

Ag and industrial equipment.

No. Teeth	CI Part Number	Bushing	Diameter (In.)		Type	Max. Bore	Dimensions							Weight Lbs. (Approx.)	
			Outside Diameter	Hub Diameter			L1	L2	C	Y	G	X	T	With Hub	Rim Only
11	60JA11H	JA	3.000	2.662	B	1-1/4	1-1/8	1-1/8	2-1/16	3564	1164	5/8	0.459	1.36	0.46
12	60JA12H	JA	3.250	2.898	B	1-1/4	1-1/8	1-1/8	2-1/16	3564	1164	5/8	0.459	1.50	0.60
13	60JA13H	JA	3.490	3.134	B	1-1/4	1-1/8	1-1/8	2-1/16	3564	1164	5/8	0.459	1.66	0.76
14	60SH14H	SH	3.740	3.371	B	1-5/8	1-7/16	1-7/16	2-11/16	5164	2364	13/16	0.459	1.88	0.88
15	60SH15H	SH	3.980	3.607	B	1-5/8	1-7/16	1-7/16	2-11/16	5164	2364	13/16	0.459	2.08	1.08
16	60SH16H	SH	4.220	3.844	B	1-5/8	1-7/16	1-7/16	2-11/16	5164	2364	13/16	0.459	2.26	1.26
17	60SDS17H	SDS	4.460	4.082	B	2	1-1/2	1-1/2	3-3/16	5564	1964	3/4	0.459	2.38	1.38
18	60SDS18H	SDS	4.700	4.319	B	2	1-1/2	1-1/2	3-3/16	5564	1964	3/4	0.459	2.56	1.56
19	60SDS19H	SDS	4.950	4.557	B	2	1-1/2	1-1/2	3-3/16	5564	1964	3/4	0.459	2.76	1.76
20	60SDS20H	SDS	5.190	4.794	B	2	1-1/2	1-1/2	3-3/16	5564	1964	3/4	0.459	3.00	2.00
21	60SDS21H	SDS	5.430	5.032	B	2	1-1/2	1-1/2	3-3/16	5564	1964	3/4	0.459	3.20	2.20
22	60SDS22H	SDS	5.670	5.270	B	2	1-1/2	1-1/2	3-3/16	5564	1964	3/4	0.459	3.44	2.44
23	60SDS23H	SDS	5.910	5.508	B	2	1-1/2	1-1/2	3-3/16	5564	1964	3/4	0.459	3.70	2.70
24	60SDS24H	SDS	6.150	5.746	B	2	1-1/2	1-1/2	3-3/16	5564	1964	3/4	0.459	3.94	2.94
25	60SDS25H	SDS	6.390	5.984	B	2	1-1/2	1-1/2	3-3/16	5564	1964	3/4	0.459	4.24	3.24
26	60SK26H	SK	6.630	6.222	B	2-5/8	2-1/8	2-1/8	3-7/8	1-27/64	5164	1-1/4	0.459	6.18	4.18
27	60SK27H	SK	6.870	6.460	B	2-5/8	2-1/8	2-1/8	3-7/8	1-27/64	5164	1-1/4	0.459	6.52	4.52
28	60SK28H	SK	7.110	6.699	B	2-5/8	2-1/8	2-1/8	3-7/8	1-27/64	5164	1-1/4	0.459	6.72	4.72
30	60SK30H	SK	7.590	7.175	B	2-5/8	2-1/8	2-1/8	3-7/8	1-27/64	5164	1-1/4	0.459	7.34	5.34
32	60SK32H	SK	8.070	7.652	B	2-5/8	2-1/8	2-1/8	3-7/8	1-27/64	5164	1-1/4	0.459	8.10	6.10
35	60SK35H	SK	8.780	8.367	B	2-5/8	2-1/8	2-1/8	3-7/8	1-27/64	5164	1-1/4	0.459	9.42	7.42
36	60SK36H	SK	9.020	8.605	B	2-5/8	2-1/8	2-1/8	3-7/8	1-27/64	5164	1-1/4	0.459	9.70	7.70
40	60SK40H	SK	9.980	9.559	B	2-5/8	2-1/8	2-1/8	3-7/8	1-27/64	5164	1-1/4	0.459	11.56	9.56
42	60SF42H	SF	10.460	10.036	B	2-15/16	2-1/4	2-1/4	4-5/8	1-35/64	5164	1-1/4	0.459	13.78	10.78
45	60SF45H	SF	11.180	10.752	B	2-15/16	2-1/4	2-1/4	4-5/8	1-35/64	5164	1-1/4	0.459	15.40	12.40
48	60SF48H	SF	11.890	11.467	B	2-15/16	2-1/4	2-1/4	4-5/8	1-35/64	5164	1-1/4	0.459	17.26	14.26

X = Current stock item, other bore requirements are available upon request.

#80 BORED-TO-SIZE SPROCKETS

SPROCKETS

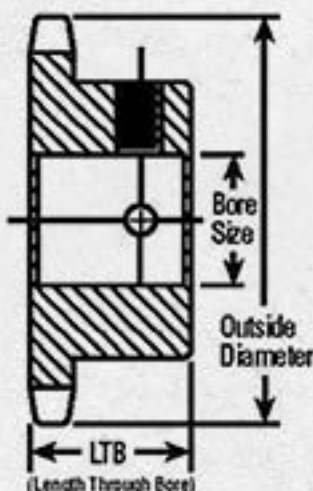

Description:

- Hardened Teeth
- Standard Keyway with (2) Setscrews
- Black Oxide Finish

Applications:

Ag and industrial equipment.

No. Teeth	CI Part Number	Diameter (in.)		LTB	Finished Bores												Weight (Lbs.)
		Outside Diameter	Hub Diameter		1	1-1/8	1-3/16	1-1/4	1-3/8	1-7/16	1-1/2	1-5/8	1-3/4	1-7/8	1-15/16	2	
10	80BS10H	3.68	2-9/16*	1-5/8	X	X	X	X	-	-	X	-	-	-	-	-	1.70
11	80BS11H	4.01	2-13/16*	1-5/8	X	X	X	X	-	X	X	-	-	-	-	-	1.80
12	80BS12H	4.33	3-1/3*	1-5/8	X	X	X	X	X	X	X	-	X	-	-	-	3.00
13	80BS13H	4.66	3	1-1/2	X	X	X	X	X	X	X	-	X	-	-	X	3.50
14	80BS14H	4.98	3-1/4	1-1/2	X	-	X	X	X	X	X	-	X	-	-	X	4.10
15	80BS15H	5.30	3-13/16	1-1/2	X	X	X	X	X	X	X	X	X	-	-	X	5.20
16	80BS16H	5.63	4	1-1/2	X	X	X	X	X	X	X	X	X	-	-	X	5.50
17	80BS17H	5.95	4	1-1/2	X	X	X	X	X	X	X	X	X	X	X	X	6.00
18	80BS18H	6.27	4-1/4	1-1/2	X	X	X	X	X	X	X	X	X	X	X	X	6.50
19	80BS19H	6.59	4-1/4	1-1/2	X	X	X	X	X	X	X	X	X	X	X	X	7.00
20	80BS20H	6.91	4-1/4	1-1/2	X	X	X	X	X	X	X	X	X	X	X	X	8.00
21	80BS21H	7.24	4-1/4	1-3/4	-	-	-	-	-	X	-	-	-	-	-	-	8.90
22	80BS22H	7.56	4-1/4	1-3/4	X	X	X	X	X	X	X	X	X	X	X	X	9.50
30	80BS30H	10.11	4-3/4	2	-	-	-	X	-	-	-	-	-	-	-	X	16.70
32	80BS32H	10.75	4-3/4	2	-	-	-	-	-	-	-	-	-	-	-	X	18.80
36	80BS36H	12.03	4-3/4	2	-	-	-	X	-	-	-	-	-	-	-	-	22.40

X = Current stock item, other bore requirements are available upon request.

#80 QD STANDARD SPROCKETS

SPROCKETS

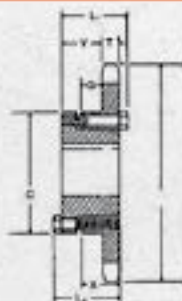

Description:

- Hardened Teeth
- For Use with QD Bushing
(see page 66)

Applications:

Ag and industrial equipment.

No. Teeth	CI Part Number	Bushing	Diameter (in.)		Type	Max. Bore	Dimensions						Weight Lbs. (Approx.)		Rim Only
			Outside Diameter	Hub Diameter			L1	L2	C	Y	G	X	T	With Hub	
11	80SH11H	SH	4.010	3.550	B	1-5/8	1-7/16	1-7/16	2-11/16	2-1/32	15/64	13/16	0.575	2.0	1.0
12	80SH12H	SH	4.330	3.864	B	1-5/8	1-7/16	1-7/16	2-11/16	2-1/32	15/64	13/16	0.575	2.4	1.4
13	80SDS13H	SDS	4.660	4.179	B	2	1-1/2	1-1/2	3-3/16	4-7/64	11/64	3/4	0.575	2.5	1.5
14	80SDS14H	SDS	4.980	4.494	B	2	1-1/2	1-1/2	3-3/16	4-7/64	11/64	3/4	0.575	2.8	1.8
15	80SK15H	SK	5.300	4.810	B	2-5/8	2-1/8	2-1/8	3-7/8	1-19/64	21/32	1-1/4	0.575	4.5	2.5
16	80SK16H	SK	5.630	5.128	B	2-5/8	2-1/8	2-1/8	3-7/8	1-19/64	21/32	1-1/4	0.575	5.1	3.1
17	80SK17H	SK	5.950	5.442	B	2-5/8	2-1/8	2-1/8	3-7/8	1-19/64	21/32	1-1/4	0.575	5.5	3.5
18	80SK18H	SK	6.270	5.759	B	2-5/8	2-1/8	2-1/8	3-7/8	1-19/64	21/32	1-1/4	0.575	5.9	3.9
19	80SK19H	SK	6.590	6.078	B	2-5/8	2-1/8	2-1/8	3-7/8	1-19/64	21/32	1-1/4	0.575	6.4	4.4
20	80SF20H	SF	6.910	6.392	B	2-15/16	2-1/4	2-1/4	4-5/8	1-27/64	21/32	1-1/4	0.575	8.3	5.3
21	80SF21H	SF	7.240	6.710	B	2-15/16	2-1/4	2-1/4	4-5/8	1-27/64	21/32	1-1/4	0.575	8.7	5.7
22	80SF22H	SF	7.560	7.027	B	2-15/16	2-1/4	2-1/4	4-5/8	1-27/64	21/32	1-1/4	0.575	9.3	6.3
23	80SF23H	SF	7.880	7.344	B	2-15/16	2-1/4	2-1/4	4-5/8	1-27/64	21/32	1-1/4	0.575	9.8	6.8
24	80SF24H	SF	8.200	7.661	B	2-15/16	2-1/4	2-1/4	4-5/8	1-27/64	21/32	1-1/4	0.575	10.5	7.5
25	80SF25H	SF	8.520	7.979	B	2-15/16	2-1/4	2-1/4	4-5/8	1-27/64	21/32	1-1/4	0.575	11.0	8.0
26	80SF26H	SF	8.840	8.298	B	2-15/16	2-1/4	2-1/4	4-5/8	1-27/64	21/32	1-1/4	0.575	11.6	8.6
27	80SF27H	SF	9.160	8.614	B	2-15/16	2-1/4	2-1/4	4-5/8	1-27/64	21/32	1-1/4	0.575	12.4	9.4
28	80SF28H	SF	9.480	8.931	B	2-15/16	2-1/4	2-1/4	4-5/8	1-27/64	21/32	1-1/4	0.575	13.2	10.2
30	80SF30H	SF	10.110	9.567	B	2-15/16	2-1/4	2-1/4	4-5/8	1-27/64	21/32	1-1/4	0.575	14.3	11.3
32	80SF32H	SF	10.750	10.202	B	2-15/16	2-1/4	2-1/4	4-5/8	1-27/64	21/32	1-1/4	0.575	16.0	13.0

#40 SERIES WELD-ON SPROCKETS

SPROCKETS



Description:

- Plate Sprocket
- See Pg. 52-54 for Weld-On Hubs

Applications:

Used with Weld-On hubs or no hub applications.

Teeth	Part #	Hub Used	Sprocket Bore (in.)	Approx. Weight
11	40V11	V	1-1/8	0.16
12	40V12	V	1-1/8	0.19
13	40V13	V	1-1/8	0.19
14	40V14	V	1-1/8	0.19
15	40V15	V	1-1/8	0.25
16	40W16	W	1-5/8	0.19
17	40W17	W	1-5/8	0.25
18	40W18	W	1-5/8	0.32
19	40W19	W	1-5/8	0.32
20	40X20	X	2	0.32
21	40X21	X	2	0.38
22	40X22	X	2	0.44
23	40X23	X	2	0.50
24	40X24	X	2	0.56
25	40X25	X	2	0.62
26	40X26	X	2	0.69
27	40X27	X	2	0.78
28	40X28	X	2	0.88
29	40VX29	X	2	0.94
30	40X30	X	2	1.00
31	40X31	X	2	1.06
32	40X32	X	2	1.13
33	40X33	X	2	1.20
34	40X34	X	2	1.28

SEE NEXT PAGE FOR MORE SIZES

#40 SERIES WELD-ON SPROCKETS

SPROCKETS



Description:

- Plate Sprocket
- See Pg. 52-54 for Weld-On Hubs

Applications:

Used with Weld-On hubs or no hub applications.

Teeth	Part #	Hub Used	Sprocket Bore (in.)	Approx. Weight
35	40X35	X	2	1.38
36	40X36	X	2	1.50
38	40X38	X	2	1.74
39	40X39	X	2	1.86
40	40X40	X	2	2.00
41	40X41	X	2	2.11
42	40X42	X	2	2.22
43	40X43	X	2	2.33
44	40X44	X	2	2.44
45	40X45	X	2	2.56
46	40X46	X	2	2.70
48	40X48	X	2	3.06
50	40X50	X	2	3.50
54	40X54	X	2	4.14
60	40X60	X	2	5.50
72	40X72	X	2	8.10

#50 SERIES WELD-ON SPROCKETS

SPROCKETS



Description:

- Plate Sprocket
- See Pg. 52-54 for Weld-On Hubs

Applications:

Used with Weld-On hubs or no hub applications.

Teeth	Part #	Hub Used	Sprocket Bore (in.)	Approx. Weight
9	50V09	V	1-1/8	0.16
10	50V10	V	1-1/8	0.19
11	50V11	V	1-1/8	0.19
12	50W12	W	1-5/8	0.22
13	50W13	W	1-5/8	0.25
14	50W14	W	1-5/8	0.32
15	50W15	W	1-5/8	0.44
16	50W16	W	1-5/8	0.50
17	50X17	X	2	0.50
18	50X18	X	2	0.56
19	50X19	X	2	0.69
20	50X20	X	2	0.75
21	50X21	X	2	0.88
22	50X22	X	2	1.00
23	50X24	X	2	1.14
24	50X25	X	2	1.25
25	50X26	X	2	1.38
26	50X27	X	2	1.63
27	50X28	X	2	1.73
28	50X30	X	2	1.83
29	50X32	X	2	2.06
30	50X33	X	2	2.19

SEE NEXT PAGE FOR MORE SIZES

#50 SERIES WELD-ON SPROCKETS

SPROCKETS



Description:

- Plate Sprocket
- See Pg. 52-54 for Weld-On Hubs

Applications:

Used with Weld-On hubs or no hub applications.

Teeth	Part #	Hub Used	Sprocket Bore (in.)	Approx. Weight
31	50X31	X	2	2.28
32	50X32	X	2	2.38
33	50X33	X	2	2.54
34	50X34	X	2	2.75
35	50X35	X	2	3.00
36	50X36	X	2	3.25
37	50X37	X	2	3.32
38	50X38	X	2	3.38
39	50X39	X	2	3.63
40	50X40	X	2	3.88
41	50X41	X	2	4.40
42	50X42	X	2	4.80
43	50X43	X	2	5.20
44	50X44	X	2	5.30
45	50X45	X	2	5.60
46	50X46	X	2	5.70
48	50X48	X	2	6.30
50	50X50	X	2	7.10
52	50X52	X	2	7.80
54	50X54	X	2	8.10
60	50X60	X	2	10.50
72	50X72	X	2	15.50

#60 SERIES WELD-ON SPROCKETS

SPROCKETS



Description:

- Plate Sprocket
- See Pg. 52-54 for Weld-On Hubs

Applications:

Used with Weld-On hubs or no hub applications.

Bulk									
Teeth	Part #	Hub Used	Sprocket Bore (in.)	Approx. Weight	Teeth	Part #	Hub Used	Sprocket Bore (in.)	Approx. Weight
9	60V09C	V	1-1/8	0.32	30	60X30C	X	2	4.50
10	60V10C	V	1-1/8	0.38	32	60X32C	X	2	5.13
11	60W11C	W	1-5/8	0.38	33	60X33C	X	2	5.44
12	60W12C	W	1-5/8	0.44	34	60X34	X	2	5.80
13	60W13C	W	1-5/8	0.63	35	60X35	X	2	6.19
14	60W14C	W	1-5/8	0.75	36	60X36	X	2	6.50
15	60X15C	X	2	0.75	37	60X37	X	2	7.10
16	60X16C	X	2	0.94	38	60X38	X	2	7.50
17	60X17C	X	2	1.19	39	60X39	X	2	7.75
18	60X18C	X	2	1.32	40	60X40	X	2	8.25
19	60X19C	X	2	1.50	41	60X41	X	2	8.60
20	60X20C	X	2	1.63	42	60X42	X	2	9.13
21	60X21C	X	2	2.00	43	60X43	X	2	9.50
22	60X22C	X	2	2.25	44	60X44	X	2	10.00
24	60X24C	X	2	2.75	45	60X45	X	2	10.90
25	60X25C	X	2	2.95	46	60X46	X	2	11.80
26	60X26C	X	2	3.25	48	60X48	X	2	12.20
27	60X27C	X	2	3.58	54	60X54	X	2	15.60
28	60X28C	X	2	3.75					

#80 SERIES WELD-ON SPROCKETS

SPROCKETS



Description:

- Plate Sprocket
- See Pg. 52-54 for Weld-On Hubs

Applications:

Used with Weld-On hubs or no hub applications.

Teeth	Bulk			
	Part #	Hub Used	Sprocket Bore (in.)	Approx. Weight
9	80W09	W	1-5/8	0.50
10	80W10	W	1-5/8	0.70
11	80W11	W	1-5/8	0.90
12	80X12	X	2	1.20
13	80X13	X	2	1.50
14	80W14	X	2	1.80
15	80X15	X	2	2.30
16	80X16	X	2	2.50
17	80X17	X	2	3.00
18	80X18	X	2	3.50
19	80X19	X	2	3.80
20	80X20	X	2	4.30
21	80X21	X	2	4.70
22	80X22	X	2	5.20
23	80X23	X	2	6.00
24	80X24	X	2	6.30
25	80X25	X	2	7.20
26	80X26	X	2	7.80
27	80X27	X	2	8.20
28	80X28	X	2	9.20
29	80X29	X	2	9.9
30	80X30	X	2	10.80

CAPTURED BEARING IDLER SPROCKETS

SPROCKETS

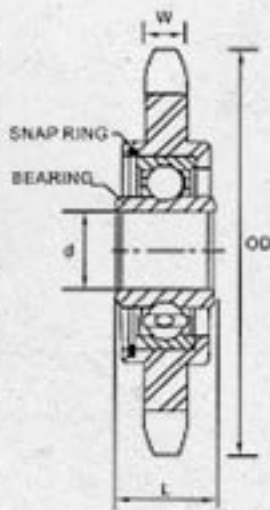

Description:

- Captured Bearing For Secure Bearing Placement
- Black Oxide Finish

Applications:

For use in extreme environment applications. Chain tensioner.

No. of Teeth	Part No.	Chain Pitch	OD	d	L	W	App. Wt. (Lbs)	Bore	Bearing Included
17	ISHD4017-12	40	2.97	0.64	0.72	0.284	0.52	1/2"	203KRR2
17	ISHD4017-58	40	2.97	0.64	0.72	0.284	0.52	5/8"	203KRR2
18	ISHD4018-12	40	3.14	0.64	0.72	0.284	0.53	1/2"	203KRR2
18	ISHD4018-58	40	3.14	0.64	0.72	0.284	0.53	5/8"	203KRR2
13	ISHD5013-12	50	2.91	0.64	0.72	0.343	0.75	1/2"	203KRR2
13	ISHD5013-58	50	2.91	0.64	0.72	0.343	0.75	5/8"	203KRR2
15	ISHD5015-12	50	3.32	0.64	0.72	0.343	0.75	1/2"	203KRR2
15	ISHD5015-58	50	3.32	0.64	0.72	0.343	0.75	5/8"	203KRR2
17	ISHD5017-12	50	3.72	0.64	0.72	0.343	0.78	1/2"	203KRR2
17	ISHD5017-58	50	3.72	0.64	0.72	0.343	0.78	5/8"	203KRR2
13	ISHD6013-12	60	3.51	0.64	0.72	0.459	0.76	1/2"	203KRR2
13	ISHD6013-58	60	3.51	0.64	0.72	0.459	0.76	5/8"	203KRR2
15	ISHD6015-12	60	3.98	0.64	0.72	0.459	1.06	1/2"	203KRR2
15	ISHD6015-58	60	3.98	0.64	0.72	0.459	1.06	1/2"	203KRR2
11	ISHD8011-34	80	4.01	0.75	0.55	0.575	1.50	3/4"	6204-12-2RS
12	ISHD8012-1	80	4.36	0.75	0.55	0.575	1.50	1"	6204-12-2RS
12	ISHD8012-34	80	4.36	0.75	0.55	0.575	1.50	3/4"	6205-1-2RS

IDLER SPROCKETS W/ PRECISION BEARINGS

SPROCKETS

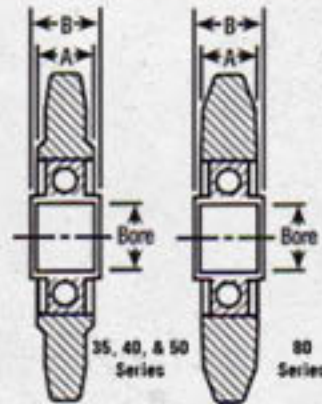

Description:

- Precision Bearing
- Black Oxide Finish

Applications:

Removes slack in chain on drive systems.

Part No.	Chain Size	No. of Teeth	Bore (in.)	A (in.)	B (in.)	Approx. Weight
IS3518-12	35	18	1/2	7/16	11/16	0.25
IS3518-58	35	18	5/8	7/16	11/16	0.25
IS4015-12	40	15	1/2	7/16	11/16	0.40
IS4015-58	40	15	5/8	7/16	11/16	0.40
IS4017-12	40	17	1/2	7/16	11/16	0.52
IS4017-58	40	17	5/8	7/16	11/16	0.52
IS5013-12	50	13	1/2	7/16	11/16	0.38
IS5013-58	50	13	5/8	7/16	11/16	0.38
IS5015-12	50	15	1/2	7/16	11/16	0.75
IS5015-58	50	15	5/8	7/16	11/16	0.75
IS5017-12	50	17	1/2	7/16	11/16	0.69
IS5017-58	50	17	5/8	7/16	11/16	0.63
IS6011-12	60	11	1/2	7/16	11/16	0.50
IS6011-58	60	11	5/8	7/16	11/16	0.50
IS6013-12	60	13	1/2	7/16	11/16	0.76
IS6013-58	60	13	5/8	7/16	11/16	0.76
IS6015-12	60	15	1/2	7/16	11/16	0.94
IS6015-58	60	15	5/8	7/16	11/16	0.88
IS8011-34	80	11	3/4	9/16	9/16	1.06
IS8012-34	80	12	3/4	9/16	11/16	1.48
IS8012-1	80	12	1	9/16	13/16	1.44

No extended Race on #80 Series Idlers

SHEAVES



SINGLE GROOVE CAST IRON SHEAVE - H BUSHED

SHEAVES

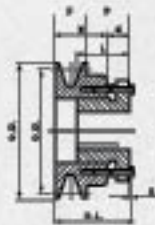

TYPE 1



TYPE 2

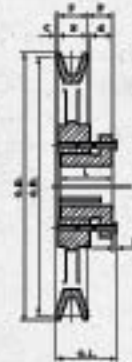

TYPE 3

Description:

- Light Duty Sheave
- A-B Combination Groove
- For Use with H Bushings (see pg. 6)

Applications:

Fractional HP Motors.
Use with H Bushings

Part No.	Diameters (in.)			Type	Dimensions (in.)								Wt. Less Bush (Lbs.)
	Outside	Datum "A"	Datum "B"		O.L.	F	L	P	C	X	G	E	
BK30H	3.15	2.40	2.80	1	1-15/16	7/8	1-1/4	7/8	-	1-5/16	7/16	3/16	1.20
BK32H	3.35	2.60	3.00	1	1-15/16	7/8	1-1/4	7/8	-	1-5/16	7/16	3/16	1.40
BK34H	3.55	2.80	3.20	1	1-15/16	7/8	1-1/4	7/8	-	1-5/16	7/16	3/16	1.60
BK36H	3.75	3.00	3.40	2	1-1/2	7/8	1-1/4	7/16	-	7/8	7/16	3/16	1.20
BK40H	3.95	3.20	3.60	2	1-1/2	7/8	1-1/4	7/16	-	7/8	7/16	3/16	1.40
BK45H	4.25	3.50	3.90	2	1-1/2	7/8	1-1/4	7/16	-	7/8	7/16	3/16	1.80
BK47H	4.45	3.70	4.10	2	1-1/2	7/8	1-1/4	7/16	-	7/8	7/16	3/16	2.20
BK50H	4.75	4.00	4.40	2	1-1/2	7/8	1-1/4	7/16	-	7/8	7/16	3/16	2.00
BK52H	4.95	4.20	4.60	2	1-1/2	7/8	1-1/4	7/16	-	7/8	7/16	3/16	2.10
BK55H	5.25	4.50	4.90	2	1-1/2	7/8	1-1/4	7/16	-	7/8	7/16	3/16	2.70
BK57H	5.45	4.70	5.10	2	1-1/2	7/8	1-1/4	7/16	-	7/8	7/16	3/16	2.70
BK60H	5.75	5.00	5.40	2	1-1/2	7/8	1-1/4	7/16	-	7/8	7/16	3/16	2.50
BK62H	5.95	5.20	5.60	2	1-1/2	7/8	1-1/4	7/16	-	7/8	7/16	3/16	2.60
BK65H	6.25	5.50	5.90	2	1-1/2	7/8	1-1/4	7/16	-	7/8	7/16	3/16	2.80
BK67H	6.45	5.70	6.10	2	1-1/2	7/8	1-1/4	7/16	-	7/8	7/16	3/16	2.90
BK70H	6.75	6.00	6.40	3	1-9/16	7/8	1-1/4	1/2	1/16	7/8	7/16	3/16	2.80

X = Current stock item, other bore requirements are available upon request.

*Do not use these "BK" sheaves with "B" gripnotch belt ratings.

SINGLE GROOVE CAST IRON SHEAVE - H BUSHED

SHEAVES

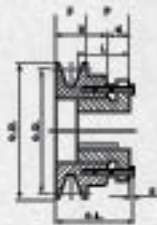

TYPE 1

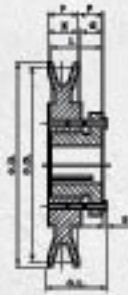

TYPE 2

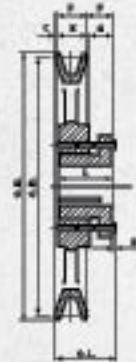

TYPE 3

Description:

- Light Duty Sheave
- A-B Combination Groove
- For Use with H Bushings
(see pg. 65)

Applications:

Fractional HP Motors.
Use with H Bushings

Part No.	Diameters (in.)			Type	Dimensions (in.)								Wt. Less Bush (Lbs.)
	Outside	Datum "A"	Datum "B"		O.L.	F	L	P	C	X	G	E	
BK72H	6.95	6.20	6.60	3	1-9/16	7/8	1-1/4	1/2	1/16	7/8	7/16	3/16	3.10
BK75H	7.25	6.50	6.90	3	1-9/16	7/8	1-1/4	1/2	1/16	7/8	7/16	3/16	3.30
BK77H	7.45	6.70	7.10	3	1-9/16	7/8	1-1/4	1/2	1/16	7/8	7/16	3/16	3.80
BK80H	7.75	7.00	7.40	3	1-9/16	7/8	1-1/4	1/2	1/16	7/8	7/16	3/16	3.40
BK85H	8.25	7.50	7.90	3	1-9/16	7/8	1-1/4	1/2	1/16	7/8	7/16	3/16	3.80
BK90H	8.75	8.00	8.40	3	1-9/16	7/8	1-1/4	1/2	1/16	7/8	7/16	3/16	4.30
BK95H	9.25	8.50	8.90	3	1-9/16	7/8	1-1/4	1/2	1/16	7/8	7/16	3/16	5.00
BK100H	9.75	9.00	9.40	3	1-9/16	7/8	1-1/4	1/2	1/16	7/8	7/16	3/16	5.20
BK105H	10.25	9.50	9.90	3	1-9/16	7/8	1-1/4	1/2	1/16	7/8	7/16	3/16	5.50
BK110H	10.75	10.00	10.40	3	1-9/16	7/8	1-1/4	1/2	1/16	7/8	7/16	3/16	6.00
BK115H	11.25	10.50	10.90	3	1-9/16	7/8	1-1/4	1/2	1/16	7/8	7/16	3/16	6.40
BK120H	11.75	11.00	11.40	3	1-9/16	7/8	1-1/4	1/2	1/16	7/8	7/16	3/16	6.90
BK130H	12.75	12.00	12.40	3	1-9/16	7/8	1-1/4	1/2	1/16	7/8	7/16	3/16	6.90
BK140H	13.75	13.00	13.40	3	1-9/16	7/8	1-1/4	1/2	1/16	7/8	7/16	3/16	8.50
BK150H	14.75	14.00	14.40	3	1-9/16	7/8	1-1/4	1/2	1/16	7/8	7/16	3/16	9.50
BK160H	15.75	15.00	15.40	3	1-9/16	7/8	1-1/4	1/2	1/16	7/8	7/16	3/16	9.80
BK190H	18.75	18.00	18.40	3	1-9/16	7/8	1-1/4	1/2	1/16	7/8	7/16	3/16	12.80

DOUBLE GROOVE CAST IRON SHEAVE - H BUSHED

SHEAVES

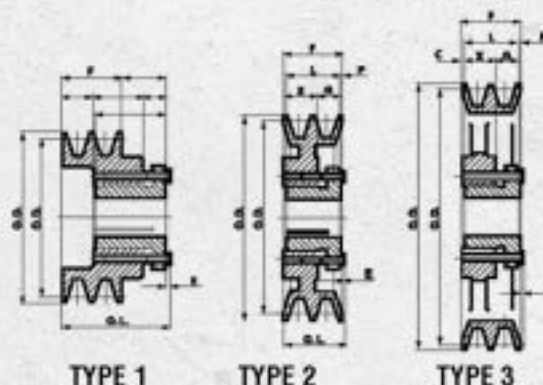

Description:

- Light Duty Sheave
- A-B Combination Groove
- For Use with H Bushings
(see pg. 65)

Applications:

Fractional HP Motors.
Use with H Bushings

Part No	Diameters (in)			Type	Weight (Lbs.)
	Outside	Datum "A"	Datum "B"		
2BK32H	3.35	2.60	3.00	1	2.10
2BK34H	3.55	2.80	3.20	1	1.6
2BK36H	3.75	3.00	3.40	1	1.9
2BK40H	3.95	3.20	3.60	1	2.3
2BK45H	4.25	3.50	3.90	1	2.6
2BK47H	4.45	3.70	4.10	2	2.8
2BK50H	4.75	4.00	4.40	2	3.3
2BK52H	4.95	4.20	4.60	2	3.3
2BK55H	5.25	4.50	4.90	2	3.3
2BK57H	5.45	4.70	5.10	2	3.7
2BK60H	5.75	5.00	5.40	2	4.1
2BK62H	5.95	5.20	5.60	2	4.5
2BK65H	6.25	5.50	5.90	3	4.5
2BK67H	6.45	5.70	6.10	3	5.1
2BK70H	6.75	6.00	6.40	3	4.9
2BK80H	7.75	7.00	7.40	3	4.8
2BK90H	8.75	8.00	8.40	3	5.0
2BK100H	9.75	9.00	9.40	3	5.0
2BK110H	10.75	10.00	10.40	3	6.6
2BK120H	11.75	11.00	11.40	3	7.2
2BK130H	12.75	12.00	12.40	3	8.4
2BK140H	13.75	13.00	13.40	3	9.4
2BK160H	15.75	15.00	15.40	3	10.4
2BK190H	18.75	18.00	18.40	3	11.8

X = Current stock item, other bore requirements are available upon request.

DOUBLE GROOVE CAST IRON SHEAVE - H BUSHED

SHEAVES

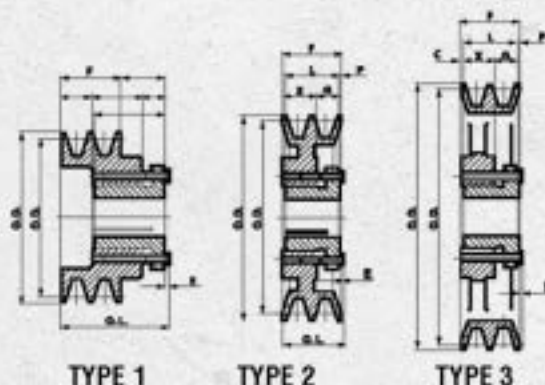

Description:

- Light Duty Sheave
- A-B Combination Groove
- For Use with H Bushings
(see pg. 65)

Applications:

Fractional HP Motors.
Use with H Bushings

Part No	Dimensions (in.)							
	O.L.	F	L	P	C	X	G	E
2BK32H	2-13/16	1-3/4	1-1/4	7/8	1-5/16	7/8	7/16	3/16
2BK34H	2-13/16	1-3/4	1-1/4	7/8	1-5/16	7/8	7/16	3/16
2BK36H	2-3/8	1-3/4	1-1/4	7/16	7/8	7/8	7/16	3/16
2BK40H	2-3/8	1-3/4	1-1/4	7/16	7/8	7/8	7/16	3/16
2BK45H	2-3/8	1-3/4	1-1/4	7/16	7/8	7/8	7/16	3/16
2BK47H	1-3/4	1-3/4	1-1/4	7/16	-	7/8	7/16	3/16
2BK50H	1-3/4	1-3/4	1-1/4	7/16	-	7/8	7/16	3/16
2BK52H	1-3/4	1-3/4	1-1/4	7/16	-	7/8	7/16	3/16
2BK55H	1-3/4	1-3/4	1-1/4	7/16	-	7/8	7/16	3/16
2BK57H	1-3/4	1-3/4	1-1/4	7/16	-	7/8	7/16	3/16
2BK60H	1-3/4	1-3/4	1-1/4	7/16	-	7/8	7/16	3/16
2BK62H	1-3/4	1-3/4	1-1/4	7/16	-	7/8	7/16	3/16
2BK65H	1-3/4	1-3/4	1-1/4	7/16	1/4	7/8	7/16	3/16
2BK67H	1-3/4	1-3/4	1-1/4	7/16	1/4	7/8	7/16	3/16
2BK70H	1-3/4	1-3/4	1-1/4	7/16	1/4	7/8	7/16	3/16
2BK80H	1-3/4	1-3/4	1-1/4	7/16	1/4	7/8	7/16	3/16
2BK90H	1-3/4	1-3/4	1-1/4	7/16	1/4	7/8	7/16	3/16
2BK100H	1-3/4	1-3/4	1-1/4	7/16	1/4	7/8	7/16	3/16
2BK110H	1-3/4	1-3/4	1-1/4	7/16	1/4	7/8	7/16	3/16
2BK120H	1-3/4	1-3/4	1-1/4	7/16	1/4	7/8	7/16	3/16
2BK130H	1-3/4	1-3/4	1-1/4	7/16	1/4	7/8	7/16	3/16
2BK140H	1-3/4	1-3/4	1-1/4	7/16	1/4	7/8	7/16	3/16
2BK160H	1-3/4	1-3/4	1-1/4	7/16	1/4	7/8	7/16	3/16
2BK190H	1-3/4	1-3/4	1-1/4	7/16	1/4	7/8	7/16	3/16

TRIPLE GROOVE CAST IRON SHEAVES - H BUSHED

SHEAVES

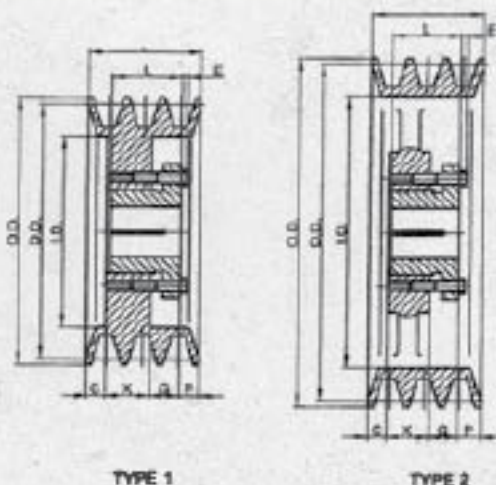

Description:

- Light Duty Sheave
- A-B Combination Groove
- For Use with H Bushings
(see pg. 65)

Applications:

Fractional HP Motors.
Use with H Bushings

Part No	Diameters				Type	Dimensions							Weight (Lbs.)
	Outside	Datum "A"	Datum "B"	Inside		F	L	P	C	X	G	E	
3BK45H	4.25	3.50	3.90	2-5/8"	2	2-1/2"	1-1/4"	1/2"	11/16"	7/8"	7/16"	3/16"	3.90
3BK47H	4.45	3.70	4.10	2-11/16"	2	2-1/2"	1-1/4"	1/2"	11/16"	7/8"	7/16"	3/16"	4.20
3BK50H	4.75	4.00	4.40	3"	2	2-1/2"	1-1/4"	1/2"	11/16"	7/8"	7/16"	3/16"	4.40
3BK57H	5.45	4.70	5.10	3-11/16"	2	2-1/2"	1-1/4"	1/2"	11/16"	7/8"	7/16"	3/16"	5.30
3BK62H	5.95	5.20	5.60	4-3/16"	3	2-1/2"	1-1/4"	1/2"	11-16"	7/8"	7/16"	3/16"	5.80
3BK90H	8.75	8.00	8.40	7"	3	2-1/2"	1-1/4"	27/32"	11/32"	7/8"	7/16"	3/16"	9.80
3BK100H	9.75	9.00	9.40	8"	3	2-1/2"	1-1/4"	27/32"	11/32"	7/8"	7/16"	3/16"	10.90
3BK110H	10.75	10.00	10.40	9"	3	2-1/2"	1-1/4"	27/32"	11/32"	7/8"	7/16"	3/16"	12.10
3BK120H	11.75	11.00	11.40	10"	3	2-1/2"	1-1/4"	27/32"	11/32"	7/8"	7/16"	3/16"	14.30

SINGLE GROOVE CAST IRON SHEAVES - FINISHED BORE

SHEAVES

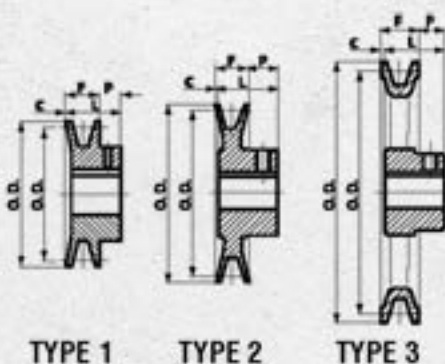

Description:

- Light Duty Sheave
- Keyway with Set Screw
- A-B Combination Groove

Applications:

Fractional HP Motors.

Part Not.	Diameters (in.)			Type	Finished Bore (in.)									Dimensions (in.)				Weight (Lbs.)
	Outside	Datum "A"	Datum "B"		1/2	5/8	3/4	7/8	1	1-1/8	1-3/16	1-3/8	1-7/16	F	L	P	C	
BK24*	2.40	1.80	2.20	1	X	X	X	-	-	-	-	-	-	13/16	1-1/16	13/32	5/32	0.4
BK25*	2.50	1.90	2.30	1	X	X	X	X	-	-	-	-	-	13/16	1-1/16	13/32	5/32	0.5
BK26*	2.60	2.00	2.40	1	X	X	X	X	-	-	-	-	-	13/16	1-1/16	13/32	5/32	0.6
BK27*	2.70	2.10	2.50	2	X	X	X	X	-	-	-	-	-	13/16	1-1/16	13/32	5/32	0.6
BK28*	2.95	2.20	2.60	2	X	X	X	X	-	-	-	-	-	13/16	1-1/16	13/32	5/32	0.8
BK30*	3.15	2.40	2.80	2	X	X	X	X	-	-	-	-	-	13/16	1-1/16	13/32	5/32	0.8
BK32*	3.35	2.60	3.00	2	X	X	X	X	-	-	-	-	-	13/16	1-1/16	13/32	5/32	0.8
BK34	3.55	2.80	3.20	2	X	X	X	X	-	X	X	-	-	7/8	1-5/32	13/32	1/8	1.3
BK38	3.75	3.00	3.40	2	X	X	X	X	-	X	X	-	-	7/8	1-5/32	13/32	1/8	1.5
BK40	3.95	3.20	3.60	2	X	X	X	X	-	X	X	-	-	7/8	1-5/32	13/32	1/8	1.5
BK45	4.25	3.50	3.90	2	X	X	X	X	-	X	X	-	-	7/8	1-5/32	13/32	1/8	1.8
BK47	4.45	3.70	4.10	2	X	X	X	X	-	X	X	-	-	7/8	1-5/32	13/32	1/8	1.9
BK50	4.75	4.00	4.40	3	X	X	X	X	X	X	X	-	-	7/8	1-5/32	13/32	1/8	2.0
BK52	4.95	4.20	4.60	3	X	X	X	X	-	X	X	-	-	7/8	1-5/32	13/32	1/8	2.0
BK55	5.25	4.50	4.90	3	X	X	X	X	-	X	X	X	-	7/8	1-5/32	13/32	1/8	2.2
BK57	5.45	4.70	5.10	3	-	X	X	X	X	X	X	-	-	7/8	1-5/32	13/32	1/8	2.3
BK60	5.75	5.00	5.40	3	X	X	X	X	-	X	X	X	-	7/8	1-5/32	13/32	1/8	2.3

X = Current stock item, other bore requirements are available upon request.

SINGLE GROOVE CAST IRON SHEAVES - FINISHED BORE

SHEAVES

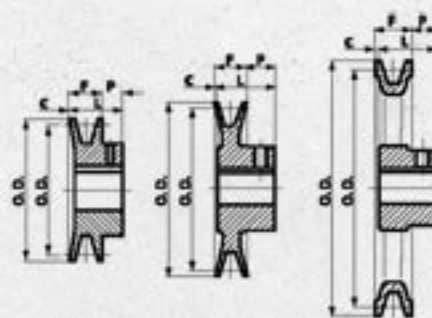

TYPE 1 TYPE 2 TYPE 3

Description:

- Light Duty Sheave
- Keyway with Set Screw
- A-B Combination Groove

Applications:

Fractional HP Motors.

Part No.	Diameters (in.)			Type	Finished Bore (in.)										Dimensions (in.)				Weight (Lbs.)
	Outside	Datum "A"	Datum "B"		1/2	5/8	3/4	7/8	1	1-1/8	1-3/16	1-3/8	1-7/16	F	L	P	C		
BK62	5.95	5.20	5.60	3	X	X	X	X	X	X	X	X	-	7/8	1-5/32	13/32	1/8	2.4	
BK65	6.25	5.50	5.90	3	-	X	X	-	-	X	X	-	-	7/8	1-5/32	13/32	1/8	2.7	
BK67	6.45	5.70	6.10	3	-	X	X	-	-	X	X	-	-	7/8	1-5/32	13/32	1/8	2.8	
BK70	6.75	6.00	6.40	3	-	X	X	-	X	X	X	X	-	7/8	1-15/32	21/32	1/16	3.3	
BK72	6.95	6.20	6.60	3	-	-	X	-	-	X	X	-	-	7/8	1-15/32	21/32	1/16	3.9	
BK75	7.25	6.50	6.90	3	-	-	X	-	-	X	X	-	-	7/8	1-15/32	21/32	1/16	3.9	
BK77	7.45	6.70	7.10	3	-	-	X	-	-	X	X	-	-	7/8	1-15/32	21/32	1/16	4.1	
BK80	7.75	7.00	7.40	3	-	X	X	X	-	X	X	X	X	7/8	1-15/32	21/32	1/16	4.4	
BK85	8.25	7.50	7.90	3	-	-	X	X	-	X	X	-	-	7/8	1-15/32	21/32	1/16	5.0	
BK90	8.75	8.00	8.40	3	-	-	X	-	X	X	X	X	-	7/8	1-15/32	21/32	1/16	5.0	
BK95	9.25	8.50	8.90	3	-	-	X	X	-	X	X	-	-	7/8	1-15/32	21/32	1/16	5.4	
BK100	9.75	9.00	9.40	3	-	-	X	-	X	X	X	X	X	7/8	1-15/32	21/32	1/16	5.6	
BK105	10.25	9.50	9.90	3	-	-	-	-	-	X	-	-	-	7/8	1-15/32	21/32	1/16	5.8	
BK110	10.75	10.00	10.40	3	-	-	X	-	-	X	X	X	-	7/8	1-15/32	21/32	1/16	6.4	
BK115	11.25	10.50	10.90	3	-	-	-	-	-	X	-	-	-	7/8	1-15/32	21/32	1/16	6.9	
BK120	11.75	11.00	11.40	3	-	-	X	-	-	X	-	X	-	7/8	1-15/32	21/32	1/16	7.4	
BK130	12.75	12.00	12.40	3	-	-	X	-	-	X	X	X	X	7/8	1-15/32	21/32	1/16	8.4	
BK140	13.75	13.00	13.40	3	-	-	X	-	-	X	-	X	-	7/8	1-15/32	21/32	1/16	9.4	
BK160	15.75	15.00	15.40	3	-	-	-	-	-	X	X	X	X	7/8	1-15/32	21/32	1/16	11.4	
BK190	18.75	18.00	18.40	3	-	-	-	-	-	X	-	X	X	7/8	1-15/32	21/32	1/16	13.4	

DOUBLE GROOVE CAST IRON SHEAVES - FINISHED BORE

SHEAVES

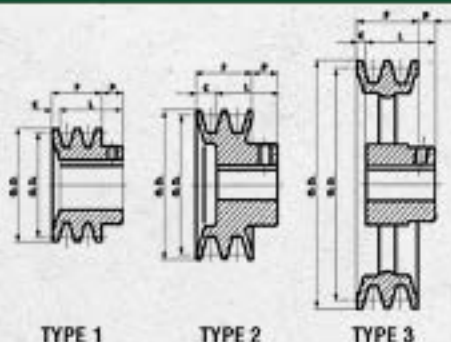

Description:

- Light Duty Sheave
- Keyway with Set Screw
- A-B Combination Groove

Applications:

Fractional HP Motors.

Part No	Diameters (in)			Type	Dimensions				Weight (Lbs.)
	Outside	Datum "A"	Datum "B"		F	L	P	C	
2BK25	2.50	1.90	2.30	1	1-3/4	1-31/32	15/32	1/4	1.3
2BK27	2.70	2.10	2.50	1	1-3/4	1-31/32	15/32	1/4	1.6
2BK28	2.95	2.20	2.60	1	1-3/4	1-31/32	15/32	1/4	1.9
2BK30	3.15	2.40	2.80	1	1-3/4	1-31/32	15/32	1/4	2.3
2BK32	3.35	2.60	3.00	1	1-3/4	1-31/32	15/32	1/4	2.6
2BK34	3.55	2.80	3.20	1	1-3/4	1-31/32	15/32	1/4	2.8
2BK36	3.75	3.00	3.40	1	1-3/4	1-31/32	15/32	1/4	3.3
2BK40	3.95	3.20	3.60	2	1-3/4	1-15/32	15/32	3/4	3.3
2BK45	4.25	3.50	3.90	2	1-3/4	1-15/32	15/32	3/4	3.3
2BK47	4.45	3.70	4.10	2	1-3/4	1-15/32	15/32	3/4	3.7
2BK50	4.75	4.00	4.40	2	1-3/4	1-15/32	15/32	3/4	4.1
2BK52	4.95	4.20	4.60	2	1-3/4	1-15/32	15/32	3/4	4.5
2BK55	5.25	4.50	4.90	2	1-3/4	1-15/32	15/32	3/4	4.5
2BK57	5.45	4.70	5.10	2	1-3/4	1-15/32	15/32	3/4	5.1
2BK60	5.75	5.00	5.40	3	1-3/4	1-15/32	15/32	3/4	4.9
2BK62	5.95	5.20	5.60	3	1-3/4	1-15/32	15/32	3/4	4.8
2BK65	6.25	5.50	5.90	3	1-3/4	1-15/32	15/32	3/4	5.0
2BK67	6.45	5.70	6.10	3	1-3/4	1-15/32	15/32	3/4	5.0
2BK70	6.75	6.00	6.40	3	1-3/4	1-19/32	11/32	1/2	6.6
2BK80	7.75	7.00	7.40	3	1-3/4	1-19/32	11/32	1/2	7.2
2BK90	8.75	8.00	8.40	3	1-3/4	1-19/32	11/32	1/2	8.4
2BK100	9.75	9.00	9.40	3	1-3/4	1-19/32	11/32	1/2	9.4
2BK110	10.75	10.00	10.40	3	1-3/4	1-19/32	11/32	1/2	10.4
2BK120	11.75	11.00	11.40	3	1-3/4	1-19/32	11/32	1/2	11.8
2BK130	12.75	12.00	12.40	3	1-3/4	1-19/32	11/32	1/2	14.9
2BK140	13.75	13.00	13.40	3	1-3/4	1-19/32	11/32	1/2	16.3
2BK160	15.75	15.00	15.40	3	1-3/4	1-19/32	11/32	1/2	18.0
2BK190	18.75	18.00	18.40	3	1-3/4	1-19/32	11/32	1/2	23.3

X = Current stock item, other bore requirements are available upon request.

DOUBLE GROOVE CAST IRON SHEAVES - FINISHED BORE

SHEAVES

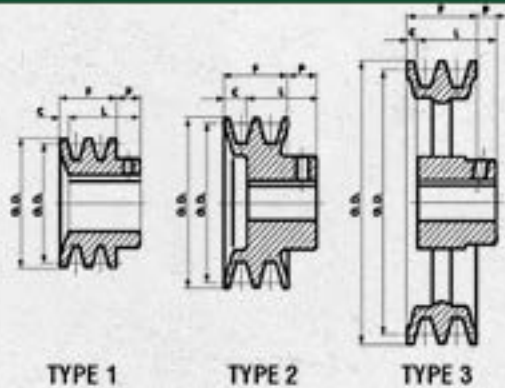

Description:

- Light Duty Sheave
- Keyway with Set Screw
- A-B Combination Groove

Applications:

Fractional HP Motors.

Part No	Finished Bores (in.)								
	1/2	5/8	3/4	7/8	1	1-1/8	1-3/16	1-3/8	1-7/16
2BK25	X	X	X	X	-	-	-	-	-
2BK27	X	X	X	X	X	-	-	-	-
2BK28	X	X	X	X	X	X	-	-	-
2BK30	X	X	X	X	X	X	-	-	-
2BK32	-	X	-	X	X	X	-	-	-
2BK34	-	X	X	X	X	X	-	-	-
2BK36	-	-	X	X	X	X	-	X	-
2BK40	-	X	X	X	X	X	-	-	-
2BK45	-	-	-	-	X	X	-	X	-
2BK47	-	-	-	X	X	X	-	-	-
2BK50	-	-	X	-	X	X	-	X	-
2BK52	-	-	-	X	X	X	-	X	-
2BK55	-	-	-	-	-	-	-	X	-
2BK57	-	-	-	-	X	X	-	X	-
2BK60	-	-	X	X	X	X	-	X	-
2BK62	-	-	-	-	X	X	-	X	-
2BK65	-	-	-	-	X	X	-	X	-
2BK67	-	-	-	-	X	X	-	X	-
2BK70	-	-	X	-	X	X	X	X	X
2BK80	-	-	X	-	X	X	X	X	X
2BK90	-	-	X	-	X	X	X	X	X
2BK100	-	-	X	-	X	X	X	X	X
2BK110	-	-	-	-	X	X	X	-	X
2BK120	-	-	-	-	X	X	X	-	X
2BK130	-	-	-	-	X	X	X	-	X
2BK140	-	-	-	-	X	X	X	-	X
2BK160	-	-	-	-	X	X	X	-	X
2BK190	-	-	-	-	X	X	X	-	X

TRIPLE GROOVE CAST IRON SHEAVES - FINISHED BORE

SHEAVES

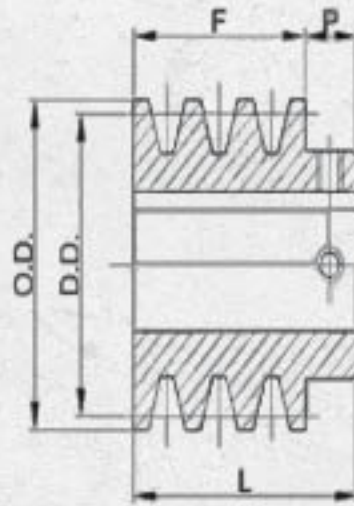

Description:

- Light Duty Sheave
- Keyway with Set Screw
- A-B Combination Groove

Applications:

Fractional HP Motors.
Use with H Bushings

Part No	Diameters (in)			Type	Stock Bores Marked "X"						Weight (Lbs.)	
	Outside	Datum "A"	Datum "B"		1"	1-1/8"	1-3/8"	1-5/8"	F	L		P
3BK32	3.35	2.60	3.00	1	X	X			2 1/2"	3	1/2"	3.40
3BK34	3.55	2.80	3.20	1	X	X	X	X	2 1/2"	3	1/2"	3.80
3BK36	3.75	3.00	3.40	1	X	X	X	X	2 1/2"	3	1/2"	4.30
3BK40	3.95	3.20	3.60	1	X	X	X		2 1/2"	3	1/2"	4.70

Bore Range	Keysets
5/8" to 7/8"	3/16" x 3/32"
15/16" to 1-1/8"	1/4" x 1/8"

X = Current stock item, other bore requirements are available upon request.

COUPLERS



ROUND AND HEX BORE SHAFT COUPLERS

COUPLERS



Description:

- Made With C1018 Cold Rolled Steel
- Black Oxide Finish
- (2) Setscrews Installed

Application:

For connecting like shafts together.

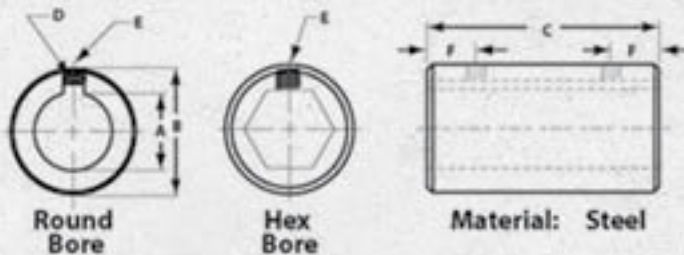

Part #	A	B	C	D	E	F	Wt. Lbs.
SHFTH-1000	5/8 HEX	1 1/2	2 1/2	NONE	2 1/4 X 20	5/8	.51
SHFTH-1200	3/4 HEX	1 5/8	3	NONE	2 1/4 X 20	5/8	.93
SHFTH-1400	7/8 HEX	1 3/4	3	NONE	2 1/4 X 20	5/8	1.32
SHFTH-1600	1 HEX	1 3/4	3	NONE	2 5/16 X 18	5/8	1.38
SHFTH-1800	1-1/8 HEX	2	4 1/2	NONE	2 5/16 X 18	1	2.69
SHFTH-2000	1-1/4 HEX	2 1/8	1 1/4	NONE	2 5/16 X 18	1	2.88
SHFTR-0800	1/2 RD	1 1/4	2	1/8	2 1/4 X 20	1/2	.56
SHFTR-1000	5/8 RD	1 1/2	2 1/2	3/16	2 1/4 X 20	5/8	1.00
SHFTR-1200	3/4 RD	1 5/8	3	3/16	2 1/4 X 20	5/8	1.38
SHFTR-1400	7/8 RD	1 3/4	3 1/2	3/16	2 1/4 X 20	3/4	1.75
SHFTR-1600	1 RD	1 5/8	3	1/4	2 5/16 X 18	5/8	1.06
SHFTR-1604	1 RD	1 3/4	4	1/4	2 5/16 X 18	7/8	1.94
SHFTR-1800	1 1/8 RD	2	4 1/2	1/4	2 5/16 X 18	7/8	2.69
SHFTR-1900	1 3/16 RD	2	4 1/2	1/4	2 5/16 X 18	7/8	2.50
SHFTR-2000	1 1/4 RD	2 1/8	4 1/2	1/4	2 5/16 X 18	1	2.88
SHFTR-2005	1 1/4 RD	2 1/8	4 1/2	5/16	2 5/16 X 18	1	2.80
SHFTR-2200	1 3/8 RD	2 5/16	4 1/2	5/16	2 3/8 X 16	1	3.38
SHFTR-2300	1 7/16 RD	2 5/16	4 1/2	3/8	2 3/8 X 16	1	3.19
SHFTR-2400	1 1/2 RD	2 1/2	4 1/2	3/8	2 3/8 X 16	1	3.88

L-JAW COUPLERS

COUPLERS



Description:

- For Low-Impact Applications
- Coupling Similar or Dis-Similar Shafts
- Black Phosphate Finish
- Requires Use of Coupling Inserts (see pg. 44-46)

Applications:

Perfect for planters, augers, hydraulic/electric motors plus a variety of other Ag, Construction, and Industrial equipment.

- L095 Series Insert Used For L090 Series Couplers
- L100 Series Insert Used For L099 Series Couplers

Stock No.	Coupling No.	Bore Size	Wt. Lbs.
L050-1/4	L050	1/4"	0.13
L050-5/16	L050	5/16"	0.13
L050-3/8	L050	3/8"	0.12
L050-7/16	L050	7/16"	0.11
L050-A	L050	1/2"	0.11
L050-B	L050	5/8"	0.1
L070-A	L070	1/2"	0.29
L070-B	L070	5/8"	0.27
L070-C	L070	3/4"	0.25
L075-7/16	L075	7/16"	0.54
L075-A	L075	1/2"	0.53
L075-B	L075	5/8"	0.51
L075-C	L075	3/4"	0.47
L075-D	L075	7/8"	0.45
L090-7/16	L090	7/16"	0.74
L090-A	L090	1/2"	0.73
L090-B	L090	5/8"	0.71
L090-C	L090	3/4"	0.7
L090-F	L090	1"	0.68
L095-7/16	L095	7/16"	0.94
L095-A	L095	1/2"	0.93
L095-9/16	L095	9/16"	0.91
L095-B	L095	5/8"	0.9
L095-C	L095	3/4"	0.87

L-JAW COUPLERS

COUPLERS



Description:

- For Low-Impact Applications
- Coupling Similar or Dis-Similar Shafts
- Black Phosphate Finish
- Requires Use of Coupling Inserts (see pg. 44-46)

Applications:

Perfect for planters, augers, hydraulic/electric motors plus a variety of other Ag, Construction, and Industrial equipment.

- L095 Series Insert Used For L090 Series Couplers
- L100 Series Insert Used For L099 Series Couplers

Stock No.	Coupling No.	Bore Size	Wt. Lbs.
L095-D	L095	7/8"	0.82
L095-E	L095	15/16"	0.8
L095-F	L095	1"	0.79
L095-G	L095	1-1/8"	0.74
L099-A	L099	1/2"	1.75
L099-B	L099	5/8"	1.7
L099-C	L099	3/4"	1.65
L100-A	L100	1/2"	1.9
L100-9/16	L100	9/16"	1.87
L100-B	L100	5/8"	1.85
L100-C	L100	3/4"	1.8
L100-D	L100	7/8"	1.73
L100-E	L100	15/16"	1.7
L100-F	L050	1"	1.65
L100-G	L100	1-1/8"	1.6
L100-I	L100	1-1/4"	1.55
L100-J	L100	1-3/8"	1.5
L110-B	L110	5/8"	4.05
L110-C	L110	3/4"	4.03
L110-D	L110	7/8"	3.95
L110-F	L110	1"	3.8
L110-G	L110	1-1/8"	3.78
L110-I	L110	1-1/4"	3.68
L110-J	L110	1-3/8"	3.58
L110-L	L110	1-1/2"	3.45
L110-N	L110	1-5/8"	3.4

L-JAW COUPLERS

COUPLINGS



Description:

- For Low-Impact Applications
- Coupling Similar or Dis-Similar Shafts
- Black Phosphate Finish
- Requires Use of Coupling Inserts (see pg. 44-46)

Applications:

Perfect for planters, augers, hydraulic/electric motors, plus a variety of other Ag, Construction and Industrial equipment.

Stock No.	Coupling No.	Bore Size	Wt. Lbs.
L075-B5/32	L075	5/8"	0.51
L090-B5/32	L090	5/8"	0.71
L095-B5/32	L095	5/8"	0.9
L099-B5/32	L099	5/8"	1.7
L100-B5/32	L100	5/8"	1.85

ROLLER CHAIN COUPLINGS

POWER TRANSMISSION

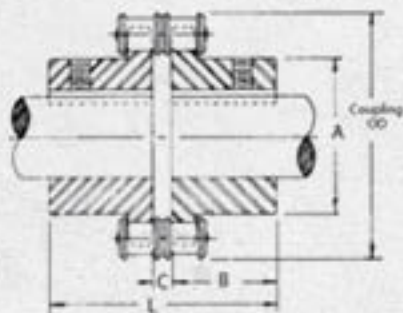

Description:

- Coupling Similar or Dis-Similar Shafts
- Flexible Couplings
- Hardened Teeth
- Standard Keyway with 2 Setscrews
- For Use with Coupling Covers and Standard Double Coupling Chain

Bored to Size Couplings w/Finished Bore

Coupling No.	Finished Bore Sizes (Includes Standard keyway and 2 Set Screws)	A	B	C	L	Coupling OD	Weight Lbs.
4012CS	1/2, 5/8, 3/4, 7/8	1.717	1.417	0.219	3.125	2.441	.55
4016CS	5/8, 3/4, 7/8, 1, 1-1/8	2.028	1.575	0.219	3.441	3.031	1.30
5016CS	5/8, 3/4, 7/8, 1, 1-1/8, 1-3/16, 1-1/4, 1-3/8, 1-7/16, 1-1/2, 1-5/8	2.520	1.772	0.382	3.925	3.779	2.20
5018CS	3/4, 7/8, 1, 1-1/8, 1-3/16, 1-1/4, 1-3/8, 1-7/16, 1-1/2, 1-5/8, 1-3/4, 1-7/8, 1-15/16	2.894	1.772	0.382	3.925	4.173	2.65
6018CS	1, 1-1/8, 1-3/16, 1-1/4, 1-3/8, 1-7/16, 1-1/2, 1-5/8, 1-3/4, 1-7/8, 1-15/16, 2, 2-1/8, 2-1/4, 2-3/8, 2-7/16	3.524	2.205	0.453	4.862	5.000	6.10
6020CS	1-1/8, 1-1/4, 1-1/2, 1-3/4, 2-1/8, 2-1/4, 2-3/8, 2-7/16, 2-5/8	4.035	2.205	0.453	4.862	5.472	7.40
8018CS	1-1/8, 1-1/4, 1-1/2, 1-3/4, 2-1/8, 2-3/8, 2-7/16, 2-5/8	4.528	2.480	0.598	5.559	6.654	13.70

Stock Bore Couplings with Minimum Plain Bores (No Keyway)

Coupling No.	Minimum Plain Bore	Max Bore	Weight Lbs.	Recommended Max. HP	Chain No.	Cover No.
4012CS-SB	7/16	7/8	0.66	5000	4012-2RC	4012-CC
4016CS-SB	5/8	1-1/8	1.50	5000	4016-2RC	4016-CC
5016CS-SB	5/8	1-5/8	2.82	4000	5016-2RC	5016-CC
5018CS-SB	3/4	1-15/16	3.53	3800	5018-2RC	5018-CC
6018CS-SB	1	2-7/16	6.35	3000	6018-2RC	6018-CC
6020CS-SB	1-1/8	2-5/8	8.43	2500	6020-2RC	6020-CC
8018CS-SB	1-1/8	2-5/8	12.61	2000	8018-2RC	8020-CC
8020CS-SB	1-1/2	2-5/8	15.17	2000	8020-2RC	8020-CC

COUPLING INSERTS



RUBBER INSERTS

INSERTS



Description:

- NBR Rubber Material

Applications:

Perfect for planters, augers, various construction equipment, and various other Ag equipment.

Stock No.	Coupling No.	Wt. Lbs.
L050NBR	L-050 Rubber Insert	0.01
L070NBR	L-070 Rubber Insert	0.02
L075NBR	L-075 Rubber Insert	0.03
L090NBR	L-090 Rubber Insert	0.04
L095NBR*	L-095 Rubber Insert	0.04
L100NBR*	L-100 Rubber Insert	0.07
L110NBR	L-110 Rubber Insert	0.16

* L095 Series Insert Used for L090 Series Couplings

* L100 Series Insert Used for L099 Series Couplings

URETHANE INSERTS

INSERTS

**Description:**

- Urethane Material

Applications:

Perfect for planters, augers, various construction equipment, and various other Ag equipment.

Stock No.	Coupling No.	Wt. Lbs.
L075UR	L-075 Urethane Insert	0.03
L095UR*	L-095 Urethane Insert	0.04
L100UR	L-100 Urethane Insert	0.07
L110UR	L-110 Urethane Insert	0.16

* L095 Series Insert Used for L090 Series Couplings

HYTREL INSERTS

INSERTS



Description:

- Hytrel Material

Applications:

Perfect for planters, augers, various construction equipment, and various other Ag equipment.

Stock No.	Coupling No.	Wt. Lbs.
L075HYT	L-075 Hytrel Insert	0.03
L095HYT*	L-095 Hytrel Insert	0.04
L100HYT	L-100 Hytrel Insert	0.07
L110HYT	L-110 Hytrel Insert	0.16

* L095 Series Insert Used for L090 Series Couplings

COLLARS



SOLID SHAFT COLLARS

COLLARS



Description:

- All Solid Shaft Collars Include Setscrew Installed
- Zinc Plated

Part #	Bore	O.D.	Width	Clap Screws	Wt. Lbs.
SC-A-18	3/16	7/16	1/4	#8-32 x 1/8	0.008
SC-A-25	1/4	1/2	5/16	#10-24 x 1/8	0.010
SC-A-31	5/16	5/8	5/16	#10-24 x 3/16	0.020
SC-A-37	3/8	3/4	3/8	1/4-20 x 3/16	0.030
SC-A-43	7/16	7/8	7/16	1/4-20 x 1/4	0.050
SC-A-50	1/2	1	7/16	1/4-20 x 1/4	0.060
SC-A-62	5/8	1-1/8	1/2	5/16-18 x 1/4	0.130
SC-A-75	3/4	1-1/4	9/16	5/16-18 x 1/4	0.130
SC-A-87	7/8	1-1/2	9/16	5/16-18 x 1/4	0.190
SC-A-93	15/16	1-1/2	9/16	5/16-18 x 1/4	0.190
SC-A-100	1	1-5/8	5/8	5/16-18 x 1/4	0.190
SC-A-112	1-1/8	1-3/4	5/8	5/16-18 x 1/4	0.250
SC-A-118	1-3/16	2	11/16	3/8-16 x 3/8	0.380
SC-A-125	1-1/4	2	11/16	3/8-16 x 3/8	0.320
SC-A-137	1-3/8	2-1/8	3/4	3/8-16 x 3/8	0.380
SC-A-143	1-7/16	2-1/4	3/4	3/8-16 x 3/8	0.440
SC-A-150	1-1/2	2-1/4	3/4	3/8-16 x 3/8	0.440
SC-A-162	1-5/8	2-1/2	13/16	3/8-16 x 3/8	0.560
SC-A-168	1-11/16	2-1/2	13/16	3/8-16 x 3/8	0.560
SC-A-175	1-3/4	2-3/4	7/8	1/2-13 x 1/2	0.690
SC-A-187	1-7/8	2-3/4	7/8	1/2-13 x 1/2	0.630
SC-A-193	1-15/16	3	7/8	1/2-13 x 1/2	0.830
SC-A-200	2	3	7/8	1/2-13 x 1/2	0.750

SINGLE SPLIT SHAFT COLLARS

COLLARS



Description:

- Split Collar for Tight Fit and Easy Removal
- Black Oxide Finish
- All Single Split Shaft Collars Include One Cap Screw Installed

Part #	Bore	O.D.	Width	Clap Screws	Wt. Lbs.
SC-SSA-18	3/16	5/8	5/16	4-40	0.008
SC-SSA-25	1/4	11/16	5/16	4-40	0.012
SC-SSA-31	5/16	11/16	5/16	4-40	0.020
SC-SSA-37	3/8	7/8	7/16	6-32	0.032
SC-SSA-43	7/16	15/16	3/8	6-32	0.052
SC-SSA-50	1/2	1-1/8	11/32	8-32	0.068
SC-SSA-62	5/8	1-5/16	7/16	10-32	0.064
SC-SSA-75	3/4	1-1/2	1/2	1/4-28	0.120
SC-SSA-87	7/8	1-5/8	1/2	1/4-28	0.176
SC-SSA-93	15/16	1-3/4	1/2	1/4-28	0.160
SC-SSA-100	1	1-3/4	1/2	1/4-28	0.220
SC-SSA-112	1-1/8	1-7/8	1/2	1/4-28	0.236
SC-SSA-118	1-3/16	2-1/16	1/2	1/4-28	0.380
SC-SSA-125	1-1/4	2-1/16	1/2	1/4-28	0.352
SC-SSA-137	1-3/8	2-1/4	9/16	1/4-28	0.412
SC-SSA-143	1-7/16	2-1/4	9/16	1/4-28	0.476
SC-SSA-150	1-1/2	2-3/8	9/16	1/4-28	0.448
SC-SSA-162	1-5/8	2-5/8	11/16	5/16-24	0.620
SC-SSA-168	1-11/16	2-3/4	11/16	5/16-24	0.590
SC-SSA-175	1-3/4	2-3/4	11/16	5/16-24	0.710
SC-SSA-187	1-7/8	2-7/8	11/16	5/16-24	0.750
SC-SSA-193	1-15/16	3	11/16	5/16-24	0.980
SC-SSA-200	2	3	11/16	5/16-24	0.930

DOUBLE SPLIT SHAFT COLLARS

COLLARS



Description:

- 2 Pieces for Assembly on Existing Shaft without Disassembly
- Black Oxide Finish
- All Double Split Shaft Collars Include Two Cap Screws Installed

Part #	Bore	O.D.	Width	Clap Screws	Wt. Lbs.
SC-DSA-18	3/16	5/8	5/16	4-40	0.008
SC-DSA-25	1/4	11/16	5/16	4-40	0.012
SC-DSA-31	5/16	11/16	5/16	4-40	0.020
SC-DSA-37	3/8	7/8	7/16	6-32	0.032
SC-DSA-43	7/16	15/16	3/8	6-32	0.052
SC-DSA-50	1/2	1-1/8	11/32	8-32	0.068
SC-DSA-62	5/8	1-5/16	7/16	10-32	0.064
SC-DSA-75	3/4	1-1/2	1/2	1/4-28	0.120
SC-DSA-87	7/8	1-5/8	1/2	1/4-28	0.176
SC-DSA-93	15/16	1-3/4	1/2	1/4-28	0.160
SC-DSA-100	1	1-3/4	1/2	1/4-28	0.220
SC-DSA-112	1-1/8	1-7/8	1/2	1/4-28	0.236
SC-DSA-118	1-3/16	2-1/16	1/2	1/4-28	0.380
SC-DSA-125	1-1/4	2-1/16	1/2	1/4-28	0.352
SC-DSA-137	1-3/8	2-1/4	9/16	1/4-28	0.412
SC-DSA-143	1-7/16	2-1/4	9/16	1/4-28	0.476
SC-DSA-150	1-1/2	2-3/8	9/16	1/4-28	0.448
SC-DSA-162	1-5/8	2-5/8	11/16	5/16-24	0.620
SC-DSA-168	1-11/16	2-3/4	11/16	5/16-24	0.590
SC-DSA-175	1-3/4	2-3/4	11/16	5/16-24	0.710
SC-DSA-187	1-7/8	2-7/8	11/16	5/16-24	0.750
SC-DSA-193	1-15/16	3	11/16	5/16-24	0.980
SC-DSA-200	2	3	11/16	5/16-24	0.930

HUBS



V SERIES WELD-ON HUBS

HUBS



Dimensions (in inches):

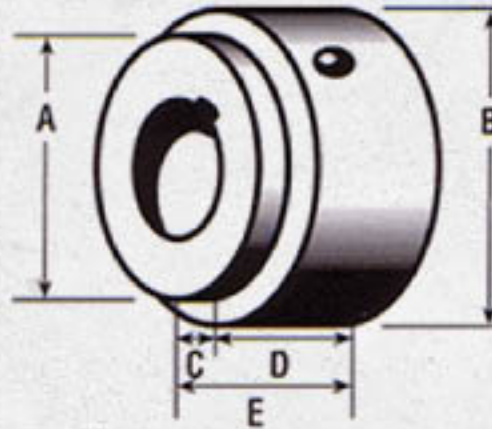

- A: 1-1/8
- B: 1-7/16
- C: 7/16
- D: 3/4
- E: 1-3/16

Fits "V" type sprockets and pulleys. Furnished with standard keyway and two set screws. Black Oxide Finish. Used with Weld-on Sprockets and One-Piece Split Steel Pulleys

Part No.	Bore Round Size (in.)	Approx. Weight
V1/2	1/2	0.38
V9/16	9/16	0.38
V5/8	5/8	0.38
V11/16	11/16	0.32
V3/4	3/4	0.32
V13/16	13/16	0.25
V7/8	7/8	0.25

W SERIES WELD-ON HUBS

HUBS



Dimensions (in inches):

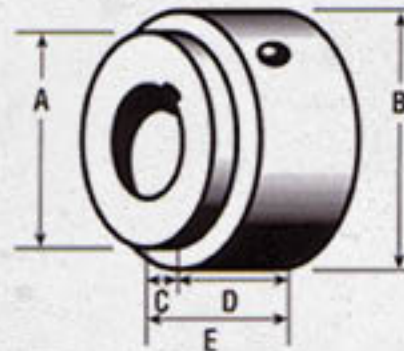

- A: 1-5/8
- B: 1-13/16
- C: 7/16
- D: 1
- E: 1-7/16

Fits "W" type sprockets and pulleys. Furnished with standard keyway and two set screws.
Black Oxide Finish. Used with Weld-on Sprockets and One-Piece Split Steel Pulleys

Part No.	Bore Round Size (in.)	Approx. Weight
W1/2	1/2	0.88
W9/16	9/16	0.88
W5/8	5/8	0.83
W11/16	11/16	0.83
W3/4	3/4	0.83
W13/16	13/16	0.75
W7/8	7/8	0.75
W15/16	15/16	0.69
W1	1	0.63
W1-1/16	1-1/16	0.63
W1-1/8	1-1/8	0.57
W1-3/16	1-3/16	0.50
W1-1/4	1-1/4	0.44

X SERIES WELD-ON HUBS

HUBS



Dimensions (in inches):

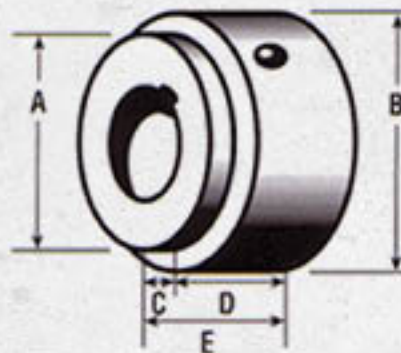

- A: 2
- B: 2-1/2
- C: 7/16
- D: 1
- E: 1-7/16

Fits "X" type sprockets and pulleys. Furnished with standard keyway and two set screws. Black Oxide Finish. Used with Weld-on Sprockets and One-Piece Split Steel Pulleys

Part No.	Bore Round Size (in.)	Approx. Weight
X1/2	1/2	0.88
X9/16	9/16	0.88
X5/8	5/8	0.83
X11/16	11/16	0.83
X3/4	3/4	0.83
X13/16	13/16	0.75
X7/8	7/8	0.75
X15/16	15/16	0.69
X1	1	0.63
X1-1/16	1-1/16	0.63
X1-1/8	1-1/8	0.57
X1-3/16	1-3/16	0.50
X1-1/4	1-1/4	0.44

DOUBLE PULLEY HUBS

HUBS



Description:

- Mild Steel
- Includes Setscrews

Application:

Use split steel pulleys to make an economical double pulley.

(See pg. 61)

Double pulley hubs are designed to eliminate any special fixtures for pulley alignment and positioning.

Part No.	Bore Size	Key Way	Sets Screws
DPH 0075	3/4"	3/16" x 3/32"	2 x 1/4-20
DPH 0875	7/8"	3/16" x 3/32"	2 x 1/4-20
DPH 1000	1"	1/4" x 1/8"	2 x 5/16-18
DPH 1125	1-1/8 "	1/4" x 1/8"	2 x 5/16-18
DPH 1250	1-1/4 "	1/4" x 1/8"	2 x 5/16-18

HEX BORE WELD-ON HUB

HUBS



Description:

- Mild Steel
- Black Oxide Finish
- Includes Setscrews

Application:

Used with weld-on sprockets and pulleys.

Part No.	Hub Series	Bore Hex Size (in.)	Approx. Weight
W9/16 HX	W	9/16	0.88
W5/8 HX	W	5/8	0.83
W3/4 HX	W	3/4	0.80
W7/8 HX	W	7/8	0.75
W1 HX	W	1	0.63
W1-1/8 HX	W	1-1/8	0.57
W1-1/4 HX	W	1-1/4	0.44
X9/16 HX	X	9/16	1.70
X5/8 HX	X	5/8	1.63
X3/4 HX	X	3/4	1.56
X7/8 HX	X	7/8	1.50
X1 HX	X	1	1.38
X1-1/8 HX	X	1-1/8	1.32
X1-1/4 HX	X	1-1/4	1.25

SPLINE BORE WELD-ON HUB

HUBS



Description:

- Mild Steel
- Black Oxide Finish
- Includes Setscrews

Application:

Used with weld-on sprockets and pulleys.

Part No.	Spline Type	Hub Series	Spline Bore Size (in.)	# of Splines	Approx. Weight
W1-1/8 SP6	6 Tooth Spline	W	1-1/8	6	0.54
W1-1/4 SP6	6 Tooth Spline	W	1-1/4	6	0.44
W1-3/8 SP6	6 Tooth Spline	W	1-3/8	6	0.38
W1-3/8 SP21	21 Tooth Spline	W	1-3/8	21	0.36
X1 SP6	6 Tooth Spline	X	1	6	1.38
X1-3/8 SP6	6 Tooth Spline	X	1-3/8	6	1.12
X1-3/8 SP21	21 Tooth Spline	X	1-3/8	21	1.10

SQUARE BORE WELD-ON HUB

HUBS



Description:

- Mild Steel
- Black Oxide Finish
- Includes Setscrew

Application:

Used with weld-on sprockets and pulleys.

Part No.	Hub Series	Square Bore Size (in.)	Approx. Weight
W1 SQ	W	1	0.63
X1 SQ	X	1	1.32
X1-1/8 SQ	X	1-1/8	1.25
X1-1/4 SQ	X	1-1/4	1.18

IDLER WELD-ON HUBS

HUBS

Description:

- For Use with Weld-On Sprockets and Pulleys
 - Precision Bearings
 - Extended Inner Race Bearings
 - Black-Oxide Finish



Produce any size Idler Sprocket or Idler Pulley

Part No.	Bore Size	Outside Diameter	Step Diameter
WIH-12	1/2"	1-13/16"	1-5/8"
WIH-58	5/8"	1-13/16"	1-5/8"
XIH-12	1/2"	2-1/4"	2"
XIH-58	5/8"	2-1/4"	2"

PULLEYS



SPLIT STEEL WELD-ON PULLEYS

PULLEYS



Description:

- A-B Combination Groove
- One Piece Split Steel Construction
- Larger Pulleys Include Weight Relief Holes

Application:

Ability to provide single and double pulleys with our standard weld-on hubs and double pulley hubs.

Part No.	Belt width	Hub Used	Pulley O.D. (in.)	Approx. Weight
VO300S	A & B	V	3	0.30
VO350S	A & B	V	3-1/2	0.45
W0400S	A & B	W	4	0.55
W0450S	A & B	W	4-1/2	0.70
W0500S	A & B	W	5	0.85
W0550S	A & B	W	5-1/2	1.05
W0600S	A & B	W	6	1.25
W0650S	A & B	W	6-1/2	1.50
W0700S	A & B	W	7	1.75
W0800S	A & B	W	8	2.25
W0900S	A & B	W	9	2.85
W1000S	A & B	W	10	3.55
W1100S	A & B	W	11	4.25
W1200S	A & B	W	12	3.95
W1400S	A & B	W	14	5.50
W1600S	A & B	W	16	6.65
X1000S	A & B	X	10	3.50
X1200S	A & B	X	12	3.90
X1400S	A & B	X	14	5.40
X1600S	A & B	X	16	6.60

KEYED SHAFTS

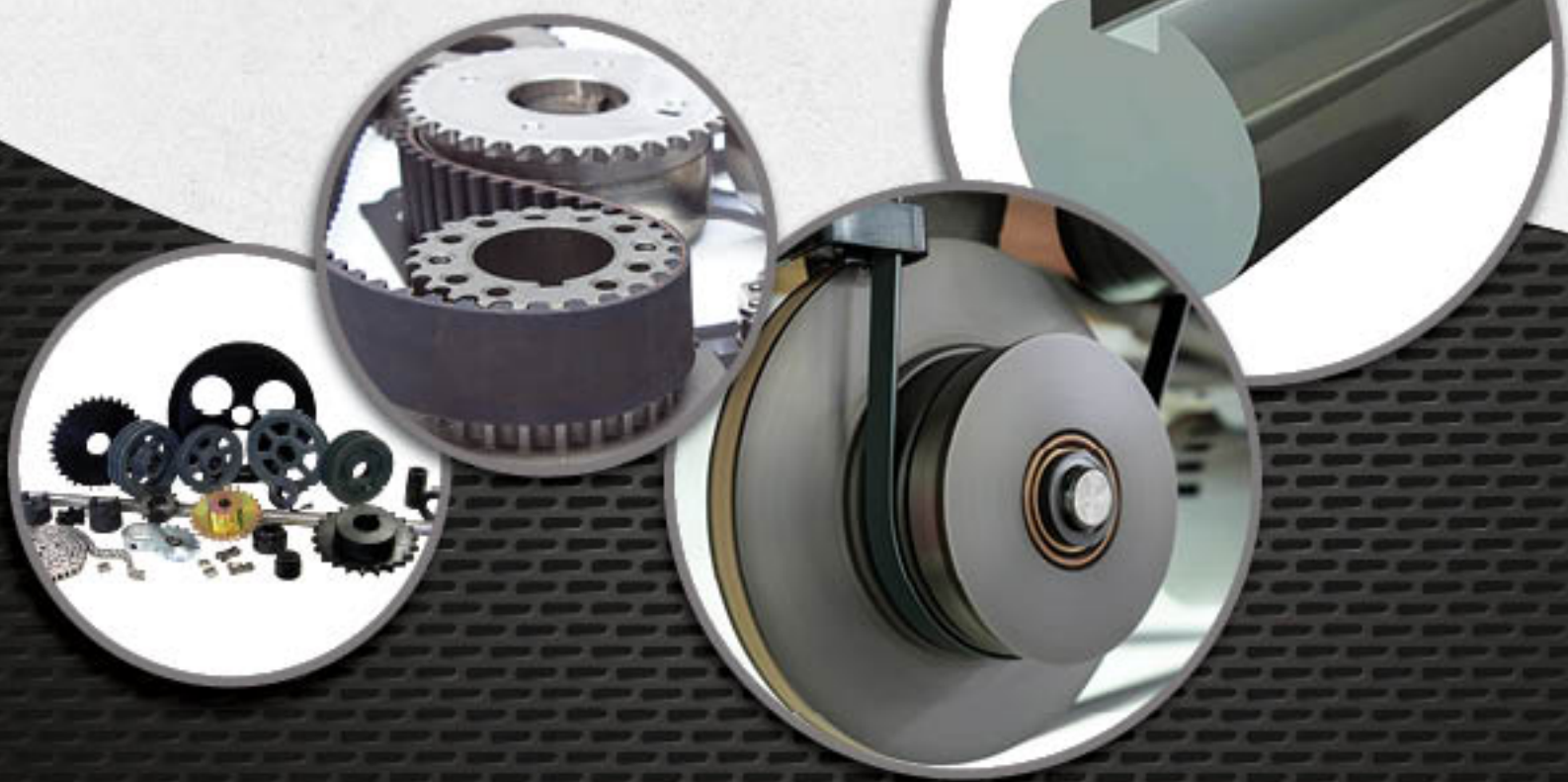

KEYED SHAFTING

KEYED SHAFTING

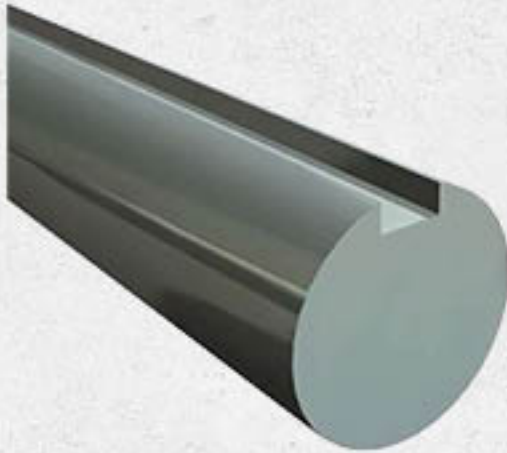

Description:

- Material 1018
- Plain Finish
- In 3ft and 6ft Lengths

Applications:

Various manufacturing applications.

3' Length				6' Length			
Diameter (A)	Nom. Key Width (B)	Shaft Length	Weight Per Piece (in lbs.)	Diameter (A)	Nom. Key Width (B)	Shaft Length	Weight Per Piece (in lbs.)
1/2"	1/8"	3 Foot	2.01	1/2"	1/8"	6 Foot	4.02
5/8"	3/16"	3 Foot	3.12	5/8"	3/16"	6 Foot	6.24
3/4"	3/16"	3 Foot	4.50	3/4"	3/16"	6 Foot	9.50
7/8"	3/16"	3 Foot	6.12	7/8"	3/16"	6 Foot	12.24
1"	1/4"	3 Foot	8.01	1"	1/4"	6 Foot	16.02
1-1/8"	1/4"	3 Foot	10.14	1-1/8"	1/4"	6 Foot	20.78
1-3/16"	1/4"	3 Foot	11.31	1-3/16"	1/4"	6 Foot	22.62
1-1/4"	1/4"	3 Foot	12.51	1-1/4"	1/4"	6 Foot	25.02
1-3/8"	5/16"	3 Foot	15.15	1-3/8"	5/16"	6 Foot	30.30
1-7/16"	3/8"	3 Foot	16.56	1-7/16"	3/8"	6 Foot	33.12
1-1/2"	3/8"	3 Foot	17.67	1-1/2"	3/8"	6 Foot	35.34

BUSHINGS



H SERIES BUSHINGS

BUSHINGS

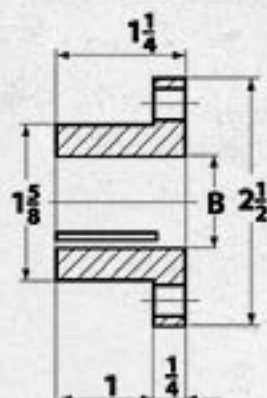

Description:

- Black Oxide Finish
- Includes Bolts

Applications:

Used with "H" series sheaves.

Inch Bore Size			Metric Bore Sizes		
Part No.	Description	Weight (Lbs.)	Part No.	Description	Weight (Lbs.)
HH-3/8	H Bushing 3/8" Bore	1.06	HH-10MM	H Bushing 10MM Bore	1.06
HH-7/16	H Bushing 7/16" Bore	1.04	HH-11MM	H Bushing 11MM Bore	1.04
HH-A	H Bushing 1/2" Bore	1.02	HH-12MM	H Bushing 12MM Bore	1.02
HH-9/16	H Bushing 9/16" Bore	1.00	HH-14MM	H Bushing 14MM Bore	1.00
HH-B	H Bushing 5/8" Bore	0.98	HH-15MM	H Bushing 15MM Bore	0.99
HH-11/16	H Bushing 11/16" Bore	0.96	HH-16MM	H Bushing 16MM Bore	0.98
HH-C	H Bushing 3/4" Bore	0.94	HH-18MM	H Bushing 18MM Bore	0.96
HH-13/16	H Bushing 13/16" Bore	0.92	HH-19MM	H Bushing 19MM Bore	0.94
HH-D	H Bushing 7/8" Bore	0.90	HH-20MM	H Bushing 20MM Bore	0.92
HH-E	H Bushing 15/16" Bore	0.88	HH-22MM	H Bushing 22MM Bore	0.90
HH-F	H Bushing 1" Bore	0.86	HH-24MM	H Bushing 24MM Bore	0.88
HH-1-1/16	H Bushing 1-1/16" Bore	0.84	HH-25MM	H Bushing 25MM Bore	0.86
HH-G	H Bushing 1-1/8" Bore	0.82	HH-28MM	H Bushing 28MM Bore	0.84
HH-H	H Bushing 1-3/16 Bore	0.80	HH-30MM	H Bushing 30MM Bore	0.82
HH-I	H Bushing 1-1/4" Bore	0.78	HH-32MM	H Bushing 32MM Bore	0.80
HH-1-5/16	H Bushing 1-5/16" Bore	0.76	HH-35MM	H Bushing 35MM Bore	0.78
HH-J	H Bushing 1-3/8" Bore	0.74	HH-36MM	H Bushing 36MM Bore	0.77
HH-K	H Bushing 1-7/16" Bore	0.72	HH-38MM	H Bushing 38MM Bore	0.76
HH-L	H Bushing 1-1/2 Bore	0.70			

QD STANDARD BUSHINGS

BUSHINGS

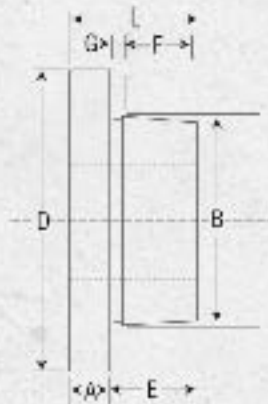

Description:

- Black Oxide Finish
- Includes Bolts

Applications:

QD standard bushing for conventional sheaves and QD sprockets.

Stock No.	Bushing Type	Bore Size	Keyway	Stock No.	Bushing Type	Bore Size	Keyway
JA Bushings				SDS Bushings			
HJA-A	JA	1/2"	1/8"	HSDS-1-11/16	SDS	1-11/16"	3/8"
HJA-B	JA	5/8"	3/16"	HSDS-38MM	SDS	38mm	10x8mm
HJA-C	JA	3/4"	3/16"	HSDS-42MM	SDS	42mm	12x8mm
HJA-D	JA	7/8"	3/16"	HSDS-C	SDS	3/4"	3/16"
HJA-F	JA	1"	1/4"	HSDS-D	SDS	7/8"	3/16"
HJA-G	JA	1-1/8"	1/4"	HSDS-F	SDS	1"	1/4"
HJA-H	JA	1-3/16"	1/4"	HSDS-G	SDS	1-1/8"	1/4"
HJA-INK	JA	1-1/4"	No	HSDS-H	SDS	1-3/16"	1/4"
SD Bushings				HSDS-I	SDS	1-1/4"	1/4"
HSD-1-11/16	SD	1-11/16"	3/8"	HSDS-J	SDS	1-3/8"	5/16"
HSD-42MM	SD	42 mm	12x8mm	HSDS-K	SDS	1-7/16"	3/8"
HSD-C	SD	3/4"	3/16"	HSDS-L	SDS	1-1/2"	3/8"
HSD-D	SD	7/8"	3/16"	HSDS-N	SDS	1-5/8"	3/8"
HSD-F	SD	1"	3/16"	HSDS-O	SDS	1-3/4"	3/8"
HSD-G	SD	1-1/8"	1/4"	HSDS-P	SDS	1-7/8"	1/2"
HSD-H	SD	1-3/16"	1/4"	HSDS-Q	SDS	1-15/16"	1/2"
HSD-I	SD	1-1/4"	1/4"	HSDS-RNK	SDS	2"	No
HSD-J	SD	1-3/8"	5/16"	SF Bushings			
HSD-K	SD	1-7/16"	3/8"	HSF-1-11/16	SF	1-11/16"	3/8"
HSD-L	SD	1-1/2"	3/8"	HSF-2-1/2	SF	2-1/2"	5/8"
HSD-N	SD	1-5/8"	3/8"	HSF-2-1/8	SF	2-1/8"	1/2"
HSD-O	SD	1-3/4"	3/8"	HSF-2-11/16	SF	2-11/16"	5/8"
HSD-P	SD	1-7/8"	1/2"	HSF-2-13/16	SF	2-13/16"	3/4"
HSD-Q	SD	1-15/16"	1/2"	HSF-2-15/16	SF	2-15/16"	3/4"
HSD-RNK	SD	2"	No	HSF-2-3/16	SF	2-3/16"	1/2"
				HSF-2-3/4	SF	2-3/4"	5/8"

QD STANDARD BUSHINGS

BUSHINGS

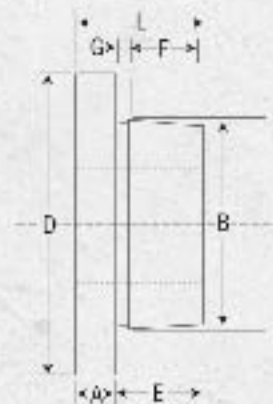

Description:

- Black Oxide Finish
- Includes Bolts

Applications:

QD standard bushing for conventional sheaves and QD sprockets.

Stock No.	Bushing Type	Bore Size	Keyway	Stock No.	Bushing Type	Bore Size	Keyway
SF Bushings				SH Bushings			
HSF-2-5/16	SF	2-5/16"	5/8"	HSH-L	SH	1-1/2"	3/8"
HSF-2-7/8	SF	2-7/8"	3/4"	HSH-N	SH	1-5/8"	3/8"
HSF-F	SF	1"	1/4"	SK Bushings			
HSF-G	SF	1-1/8"	1/4"	HSK-1-11/16	SK	1-11/16"	3/8"
HSF-I	SF	1-1/4"	1/4"	HSK-2-1/2	SK	2-1/2"	5/8"
HSF-J	SF	1-3/8"	5/16"	HSK-2-3/16	SK	2-3/16"	1/2"
HSF-K	SF	1-7/16"	3/8"	HSK-2-5/16	SK	2-5/16"	5/8"
HSF-L	SF	1-1/2"	3/8"	HSK-38MM	SK	38 mm	10x8mm
HSF-N	SF	1-5/8"	3/8"	HSK-42MM	SK	42 mm	12x8mm
HSF-O	SF	1-3/4"	3/8"	HSK-48MM	SK	48 mm	14x9mm
HSF-P	SF	1-7/8"	1/2"	HSK-F	SK	1"	1/4"
HSF-Q	SF	1-15/16"	1/2"	HSK-G	SK	1-1/8"	1/4"
HSF-R	SF	2"	1/2"	HSK-H	SK	1-3/16"	1/4"
HSF-U	SF	2-1/4"	1/2"	HSK-I	SK	1-1/4"	1/4"
HSF-V	SF	2-3/8"	5/8"	HSK-J	SK	1-3/8"	5/16"
HSF-W	SF	2-7/16"	5/8"	HSK-K	SK	1-7/16"	3/8"
HSF-Y	SF	2-5/8"	5/8"	HSK-L	SK	1-1/2"	3/8"
SH Bushings				HSK-N	SK	1-5/8"	3/8"
HSH-1-11/16	SH	1-11/16"	No	HSK-O	SK	1-3/4"	3/8"
HSH-28MM	SH	28 mm	8x7mm	HSK-P	SK	1-7/8"	1/2"
HSH-B	SH	5/8"	3/16"	HSK-Q	SK	1-15/16"	1/2"
HSH-C	SH	3/4"	3/16"	HSK-R	SK	2"	1/2"
HSH-D	SH	7/8"	3/16"	HSK-T	SK	2-1/8"	1/2"
HSH-F	SH	1"	1/4"	HSK-U	SK	2-1/4"	1/2"
HSH-G	SH	1-1/8"	1/4"	HSK-V	SK	2-3/8"	5/8"
HSH-H	SH	1-3/16"	1/4"	HSK-W	SK	2-7/16"	5/8"
HSH-I	SH	1-1/4"	1/4"	HSK-YNK	SK	2-5/8"	No
HSH-J	SH	1-3/8"	5/16"	HSK2-1/8	SK	2-1/8"	1/2"
HSH-K	SH	1-7/16"	3/8"				

CHAINS



CHAIN

ROLLER CHAIN

ANSI Chain No	Pitch	Roller Diameter	Width Between Inner Plates	Pin Diameter	Pin Length	Inner Plate Depth	Plate Thickness	Tensile Strength	Weight Per Foot
	P	B Max	W Min	D Max	L Max	H Max	T Max	Lbs Min	Lbs/Ft.
Single Strand Roller chain									
*25	.250	.130	.125	.090	.311	.236	.031	795	.10
*35	.375	.200	.187	.141	.488	.354	.051	1795	.21
41	.500	.305	.246	.141	.541	.390	.051	1516	.25
40	.500	.312	.309	.156	.654	.472	.059	3205	.42
50	.625	.400	.370	.200	.815	.594	.080	5045	.69
60	.750	.469	.494	.234	1.019	.709	.095	7227	1.00
80	1.000	.625	.620	.312	1.287	.945	.128	12886	1.71
Double Pitch Chain									
2040	1.000	.312	.309	.156	.654	.472	.059	3205	.28
C2040	1.000	.312	.309	.156	.654	.472	.059	3205	.33
2050	1.250	.400	.370	.200	.815	.590	.080	5045	.49
C2050	1.250	.400	.370	.200	.815	.590	.080	5045	.52
2080	1.500	.469	.494	.234	1.019	.709	.095	7227	.68
C2080	1.500	.469	.494	.234	1.019	.709	.095	7227	.75
2080	2.000	.625	.620	.312	1.287	.945	.128	12886	1.13
Stainless Steel									
40	.500	.312	.309	.156	.654	.472	.059	2182	.42
50	.625	.400	.370	.200	.815	.594	.080	3455	.69
60	.750	.469	.494	.234	1.019	.709	.095	4932	1.00
Heavy Roller Chain									
50H	.625	.400	.370	.200	.870	.594	.095	7500	.83
60H	.750	.469	.494	.234	1.149	.709	.128	8500	1.25
80H	1.000	.625	.620	.312	1.425	.945	.157	14500	2.07
Double Roller Chain									
40-2	.500	.312	.309	.156	1.220	.472	.059	6409	.75
50-2	.625	.400	.370	.200	1.531	.594	.080	10091	1.33
60-2	.750	.469	.494	.234	1.921	.709	.095	14455	1.95
Standard		Heavy		Double	Extended Pitch		Stainless Steel		
10' Box	Reel-length	10' Box	Reel-length	10' Box	10' Box	Reel-length	10' Box	Reel-length	
RC25B	RC25-250	RC50BH		RC40-2B	RC2040B	RC2040-100	RC40B-SS	RC40-SS-100	
RC35B	RC35-250	RC60BH	RC60H-100	RC50-2B	RC2050B	RC2050-100	RC50B-SS	RC50-SS-100	
RC41B	RC41-250	RC80BH	RC80H-50	RC60-2B	RC2060B	RC2060-100	RC60B-SS	RC60-SS-100	
RC40B	RC40-100				RC2080B				
RC50B	RC50-100				RCC2040B				
RC60B	RC60-100				RCC2050B				
RC80B	RC80-50				RCC2060B				

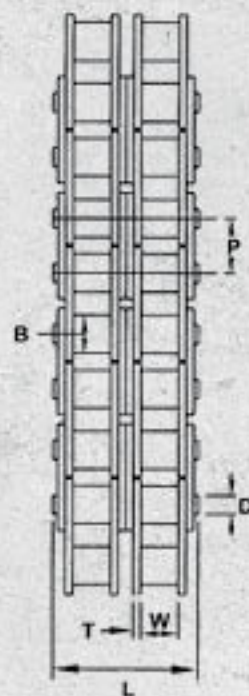
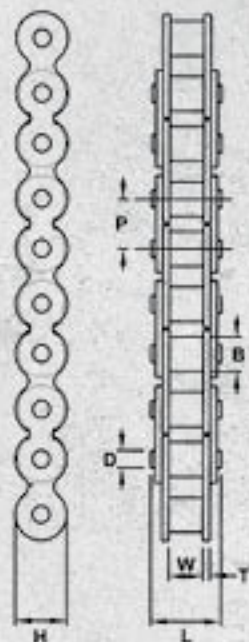

*Items listed are standard stock items. Contact us for additional sizes or lengths.



concentric™
INTERNATIONAL



SEATS

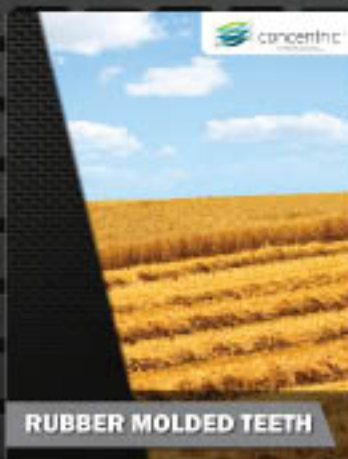

RUBBER MOLDED TEETH



ELECTRICAL PRODUCT GROUP

Learn More About All of Our Products.

www.concentricintl.com

Copyright ©2019. All Rights Reserved

A RUAN COMPANY